

TEE Transducer Care

WARNINGS

- ▶ Be sure to use the appropriate Personal Protective Equipment (PPE) whenever necessary.
- ▶ **DO NOT** skip any steps or abbreviate the cleaning process in any way.

Cautions

- ▶ **DO NOT** allow bodily fluids to dry on the transducer. Always clean the transducer immediately after use.
- ▶ **DO NOT** bend the endoscopic shaft smaller than a 20 cm (8 inch) curve.
- ▶ **DO NOT** use unapproved cleaning agents such as alcohol or bleach (for example: Sani-Cloth) as these can damage the transducer and void the warranty. For more information about approved cleaners and disinfectants, see www.sonosite.com/support/cleaners-disinfectants.
- ▶ **DO NOT** spray or immerse the controls, the cord, or the connector with any fluid. Be careful to prevent moisture from getting on the connector.
- ▶ **DO NOT** soak the transducer longer than recommended by the chemical manufacturer. Follow the manufacturer's recommendations for concentration, temperature, and duration.

Refer to the following diagram when caring for your transducer

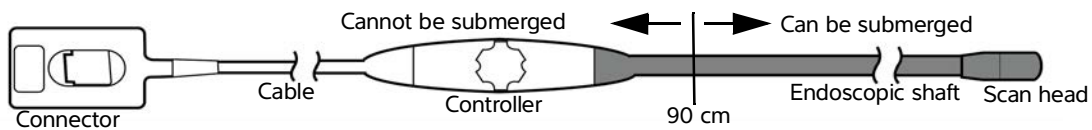

Preventing damage

STEP 1 ALWAYS use a bite guard. Remove any dentures before placing the bite guard in the patient's mouth.

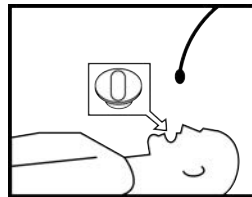

Cleaning



For a list of approved cleaners and disinfectants, refer to the cleaners and disinfection tool available at www.sonosite.com/support/cleaners-disinfectants.

STEP 2 DO NOT

allow bodily fluids to dry on the transducer. Remove all visible biological material by wiping the entire transducer, **except** the connector, with a cloth or wipe moistened with water.

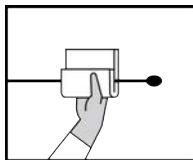

STEP 4 During the soak:

A Scrub the shaft for at least **3 min** using a soft brush or single-use endoscopic sponge moistened with cleaner.

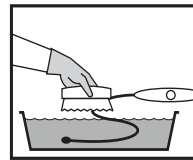

STEP 5 Rinse

the shaft for at least **3 min** in a large volume of clean, lukewarm water (for example, 8 L). **Inspect** the transducer for any remaining biological material.

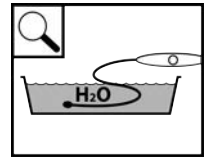

STEP 3 Place up to

90 cm of the endoscopic shaft in an **approved** cleaner. Make sure the controller cannot fall into the solution. **CHECK** the expiration date of the cleaner, and follow **ALL** chemical manufacturer's instructions for soak time and temperature.

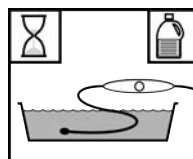

B Wipe the controller and cable with a clean, non-linting cloth or single-use endoscopic sponge moistened with cleaner. **Remove** cleaner by wiping again with a fresh cloth or sponge moistened with clean water.

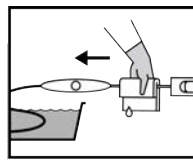

STEP 6 Dry

the transducer with a clean, non-linting towel. **Examine** the transducer and cable for any cracks. **DO NOT** use the transducer if any damage is found.

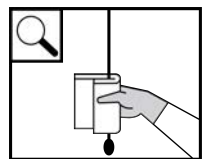

Testing for electrical leakage



For complete instructions on using the leakage tester, refer to the **ULT2000 Series User Manual**.

STEP 7 Set up the equipment.

A Insert the transducer into the transducer adapter.

B Insert the fork adapter securely in between the control wheels on the controller and do not allow it to swivel.

C Connect the splitter to the transducer adapter, the fork adapter, and the leakage tester.

D Connect the conductivity probe to the leakage tester and insert into 0.9% saline solution or Cidezyme/Enzol.

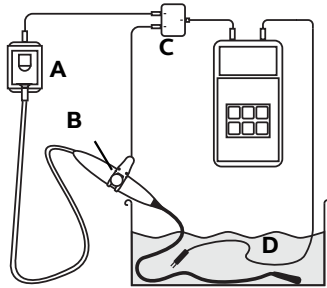

STEP 8

Make sure the tester displays **Ready for Testing**, press **FULL TEST**. Repeat the test two more times.

If any of the results are **Fail**, do not use the transducer and contact FUJIFILM SonoSite for repair.

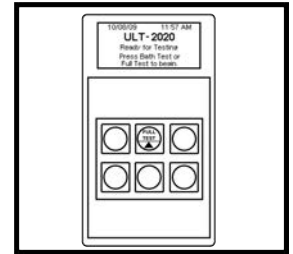

Disinfecting

STEP 9

A Place up to 90 cm of the shaft in an **approved** disinfectant. Make sure the controller cannot fall into the solution. **CHECK** the expiration date of the disinfectant, and follow **ALL** chemical manufacturer's instructions for soak time and temperature.

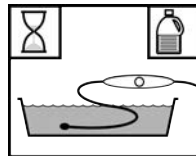

B **Wipe** the controller and cable with a sterile, non-linting cloth or single-use endoscopic sponge moistened with disinfectant. **Remove** cleaner by wiping again with a fresh sterile cloth or sponge moistened with sterile water.

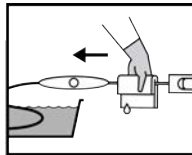

STEP 10 **Rinse** the shaft for at least **1 minute** in a large volume of sterile, deionized water (for example, 8 L). Repeat **3 separate times**. **Discard** the rinse water after each rinse.

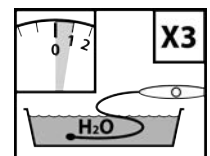

STEP 11 **Dry** the transducer with a sterile, non-linting towel or medical-grade air. **Examine** the transducer and cable for any cracks. **DO NOT** use the transducer if any damage is found.

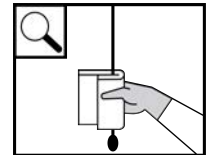

Transporting and storing

STEP 12 Transport and store the transducer in accordance with your organization's policies.

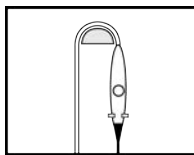

For complete instructions on cleaning, disinfecting, transporting, and storing the TEE transducer, refer to the **TEE Transducer User Guide**.

SonoSite is a registered trademark of FUJIFILM Sonosite, Inc. in various jurisdictions. FUJIFILM is a registered trademark of FUJIFILM Corporation. Value From Innovation is a trademark of FUJIFILM Holdings America Corporation. All other trademarks are the property of their respective owners.

Copyright © 2019 FUJIFILM SonoSite, Inc. All rights reserved.

P05497-09



Manufacturer:
FUJIFILM SonoSite, Inc.
 21919 30th Drive SE
 Bothell, WA 9802, USA
 T: 1-888-482-9449 or
 1-425-951-1200
 F: 1-425-951-1201

EC Authorized Representative
 FUJIFILM SonoSite B.V.
 Joop Geesinkweg 140
 1114 AB Amsterdam,
 The Netherlands

Australia Sponsor
FUJIFILM SonoSite Australasia Pty Ltd
 114 Old Pittwater Road
 Brookvale, NSW, 2100
 Australia

CE
 2797