

Sonosite MT Stand and Accessory Assembly Instructions

Manufacturer	EU Authorized Representative	UK Responsible Person	Australia Sponsor
FUJIFILM SonoSite, Inc. 21919 30th Drive SE Bothell, WA 98021 USA T: 1-888-482-9449 or 1-425-951-1200 F: 1-425-951-1201	FUJIFILM SonoSite B.V. Joop Geesinkweg 140 1114 AB Amsterdam, The Netherlands	FUJIFILM Healthcare UK Limited Fujifilm House Whitbread Way Bedford MK42 0ZE United Kingdom	FUJIFILM SonoSite Australasia Pty Ltd 114 Old Pittwater Road BROOKVALE, NSW, 2100 Australia



CAUTION

United States federal law restricts this device to sale by or on the order of a physician.

SONOSITE is a registered trademark of FUJIFILM SonoSite, Inc., in various jurisdictions. FUJIFILM and FUJIFILM VALUE FROM INNOVATION are registered trademarks of FUJIFILM Corporation in various jurisdictions. All other trademarks are the property of their respective owners.

Patent: www.sonosite.com/patents



Part number: P25675-02

Published Jun 11, 2025

Copyright © 2025 FUJIFILM SonoSite, Inc. All rights reserved.

Table of Contents

- Inside the boxes 1**
- Unpack and build the stand 4**
- Install the storage bins and optional printer 6**
- Install the optional stand batteries 10**
- Install the system battery and connect to power 14**
- Install the optional TTC and I/O hub 16**
- Install the stand platform 18**
- Connect the stand to power 20**

Inside the boxes

These items may be packaged in separate boxes.

System

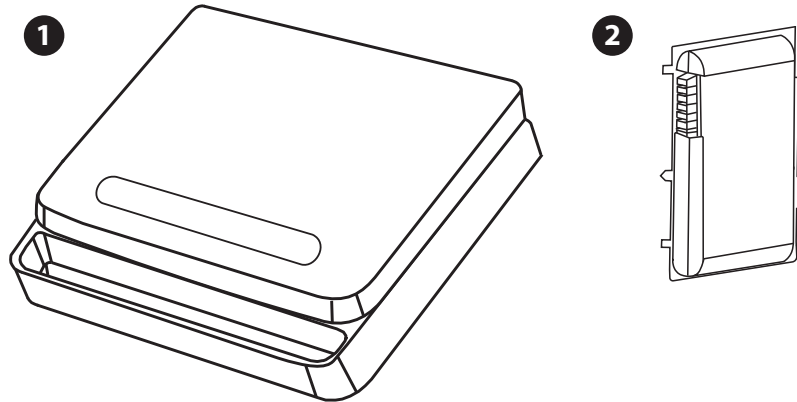

1 Sonosite MT	2 System battery
----------------------	-------------------------

Optional stand parts

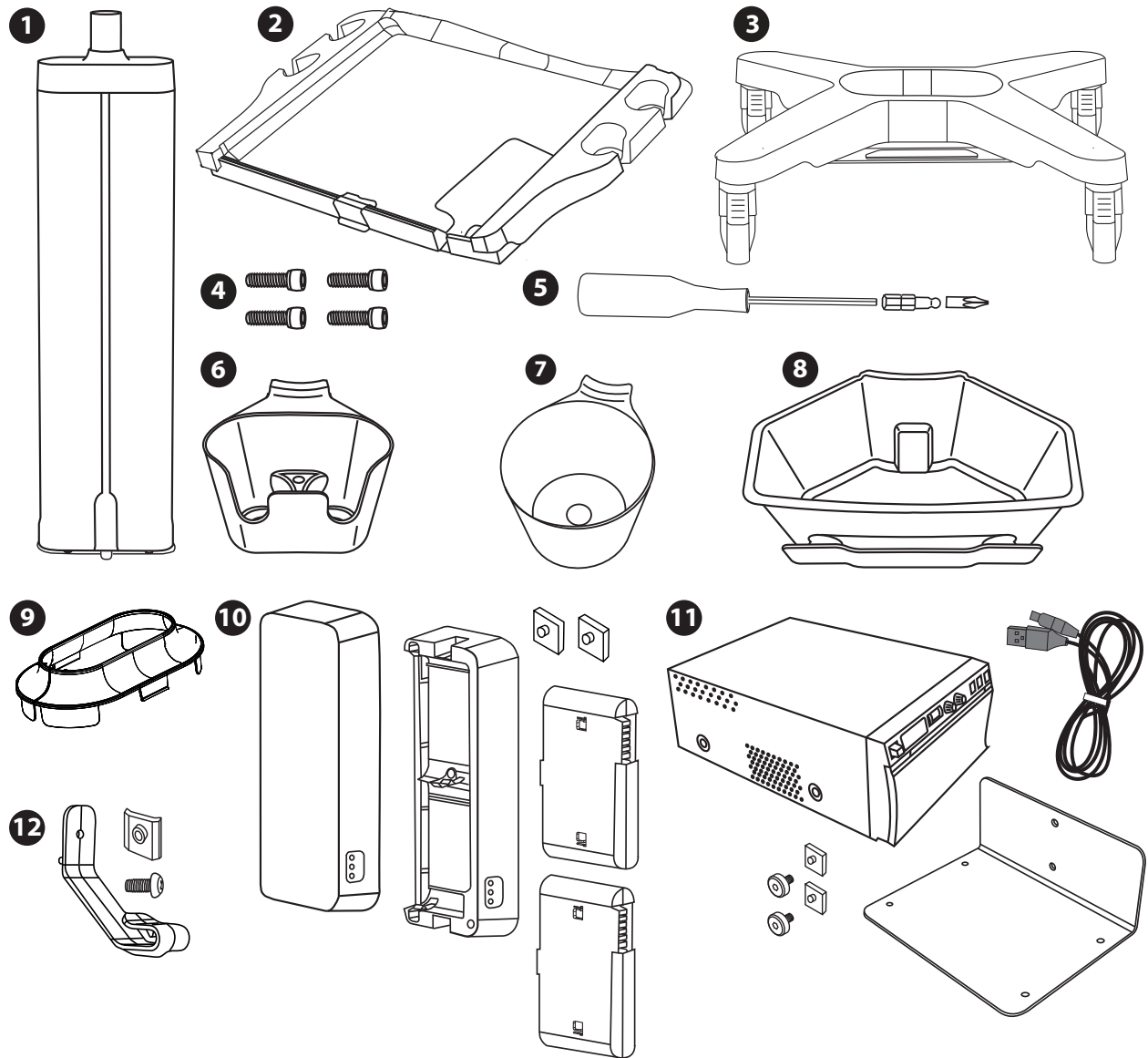

1 Stand column	2 Stand platform
3 Stand base	4 M5 x 12 mm socket screws
5 Bit driver, 4 mm ball hex bit and #2 Phillips bit	6 Gel holder
7 Wipes holder	8 Storage basket
9 Column base cover	10 Battery cover, compartment, column nut pads and batteries
11 Printer, printer storage tray, USB cable and fasteners	12 Battery cord retention hook and hardware

Optional miscellaneous parts

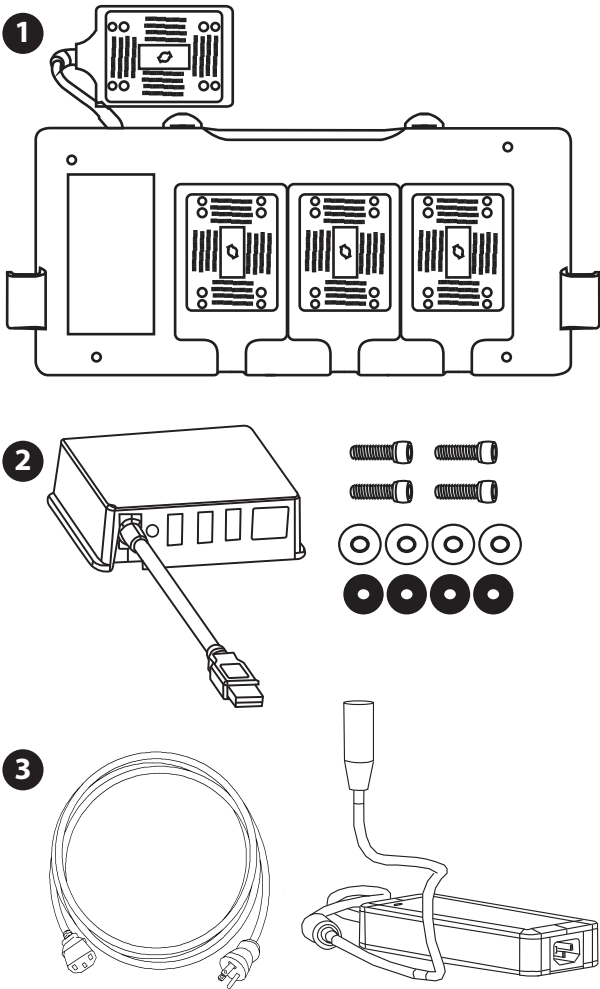

1 Triple Transducer Connector (TTC)	2 I/O Hub, USB cable, M5 X 14 mm socket screws, stainless steel and rubber washers
3 Power supply with holder and AC cable	

Unpack and build the stand

1. Open the box and then set the stand column aside.

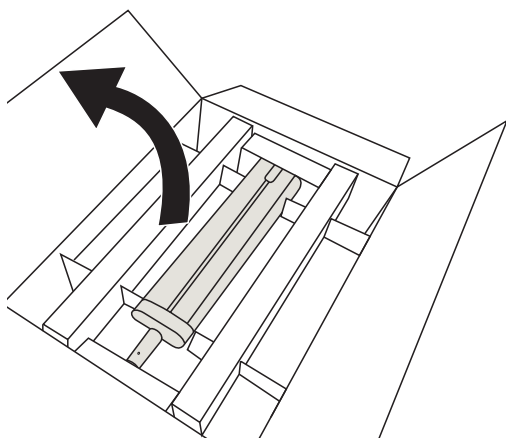

2. Remove the accessory kit and all the cardboard from inside the box.

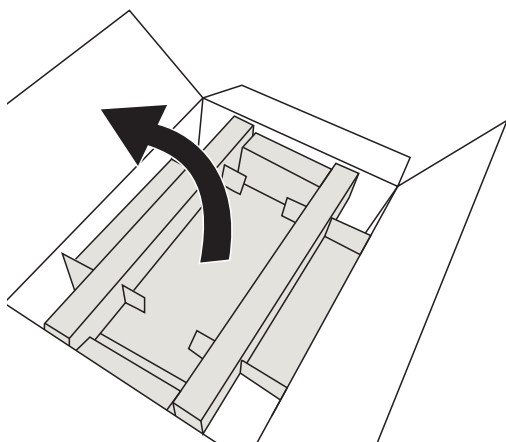

3. Remove the packing material from the base.
4. Place the base, wheel side down, on the floor.
5. Lock 2 wheels.

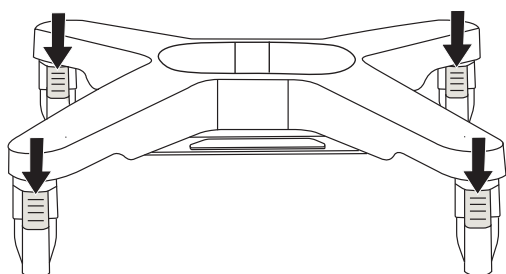

6. Locate the 2 mounting tabs on the bottom of the stand column base and align them with the holes in the stand base. Make sure the cables are inserted in the side channels of the stand. The smaller tab goes into the smaller hole towards the back of the system.

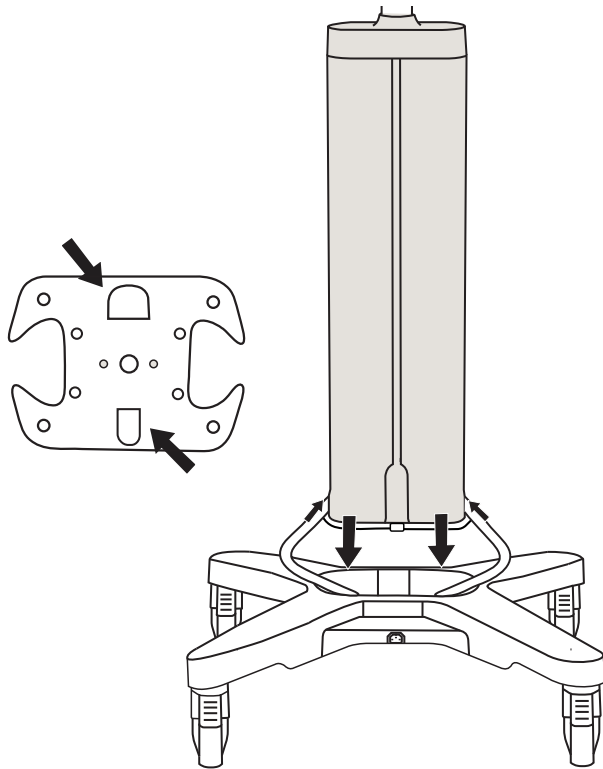

7. Use the provided 4 mm hex to secure the column to the stand with the 4 outer M5 mm x 12 mm socket screws.

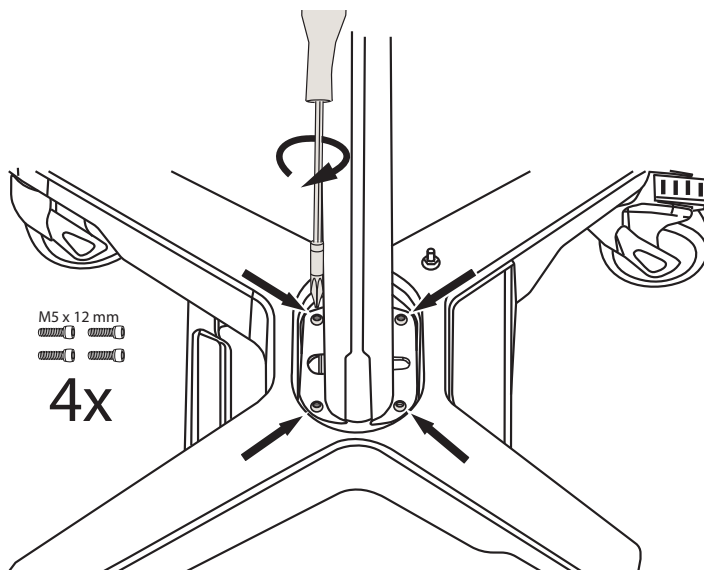

Install the storage bins and optional printer

1. Install the gel holder on one side of the stand and the wipes holder on the other.

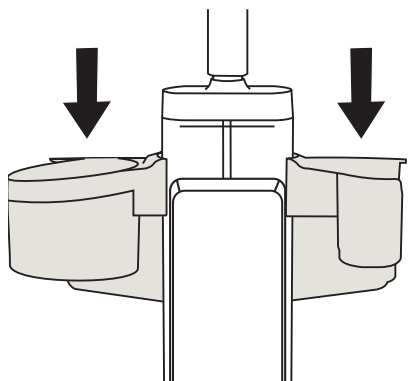

2. Hook the storage bin over the storage bin mount and press down firmly until it is seated.

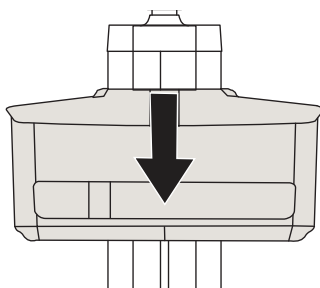
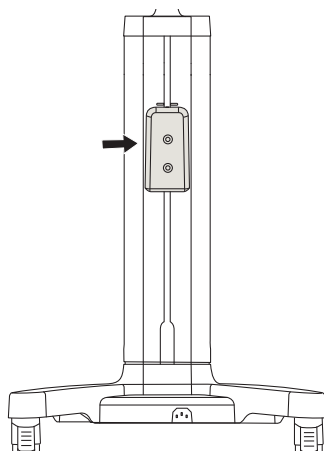

3. If you are not installing a printer, insert the cord inside the column and skip to step [10](#).

Insert 2 nut pads in the central rear column channel and then slide them up to the marks on the column.

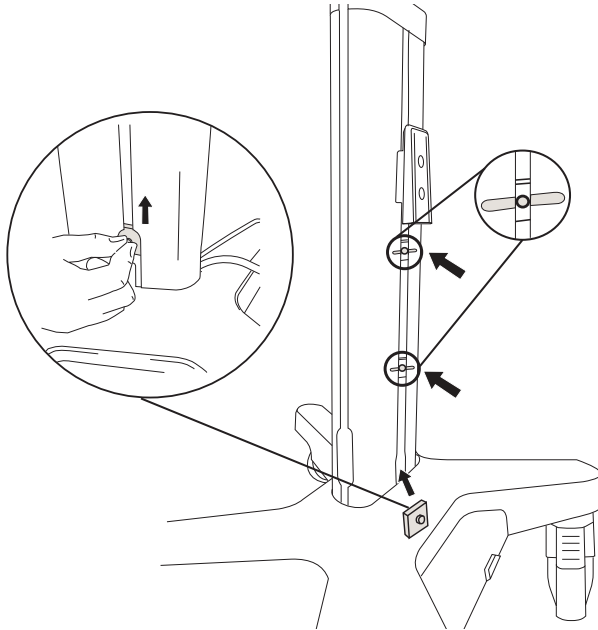

4. Slide the printer shelf up to the marks on either side of the stand channel. Secure the printer shelf with the 4 mm hex and 2 M5 hex screws.

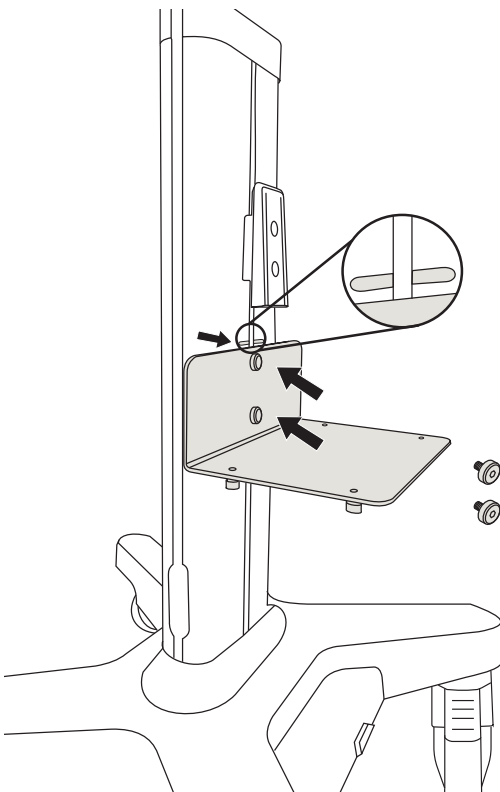

5. Set the printer on the shelf and then use the 4 thumb screws to secure it. The left thumbscrews use the holes at the rear edge of the printer. The right screws go through the rubber foot pads.

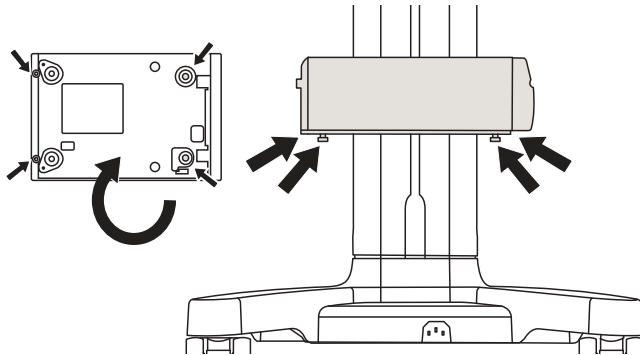

6. Remove the channel cover by sliding it down and out at the bottom of the stand column.

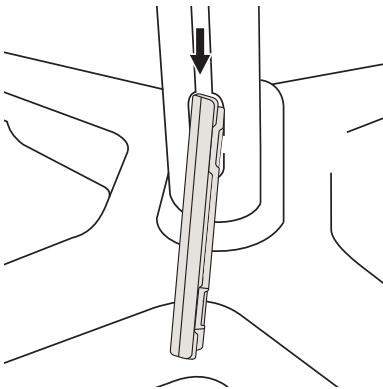

7. Connect the USB cable and run it up the channel in the side of the column. Then connect the power cable from the bottom of the stand to the printer. You may loop the cable to eliminate excess slack.

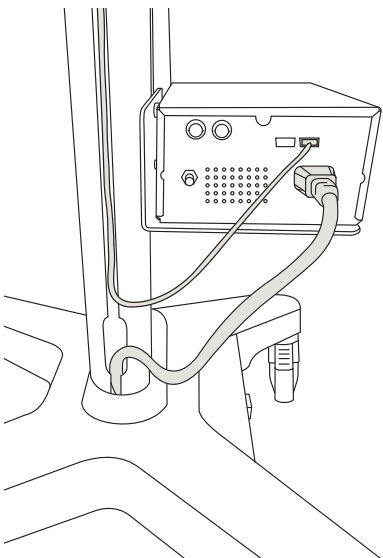

8. In both right and left channels, insert a channel cover and slide it to the middle of the stand.

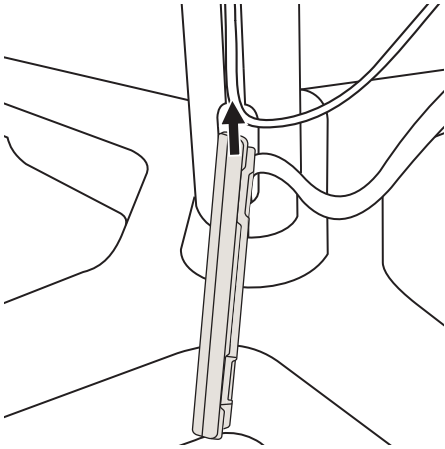

9. Insert another nut pad in the central column channel underneath the optional printer if you have one or at the top of the channel arch on the back of the column to mount the cord retention hook.

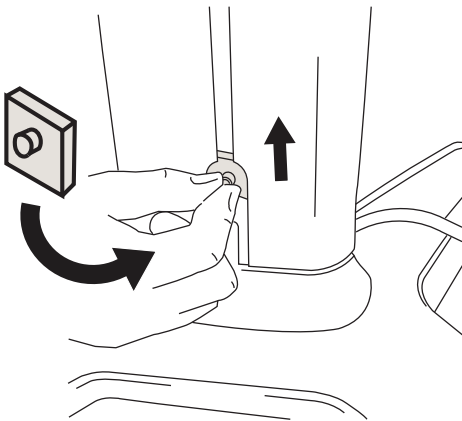

10. Line up the cord retention hook hole with the nut pad in the column channel. Insert the screw and tighten it by turning it clockwise with the hex key.

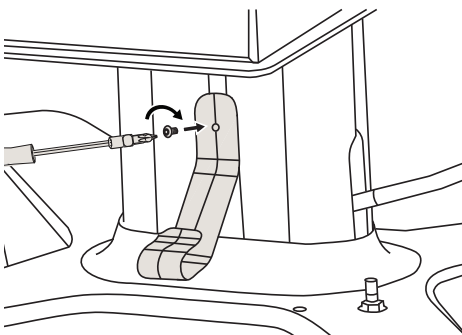

Install the optional stand batteries

1. Slide the nut plates into the central channel in the front bottom of the stand column. The bottom nut pad should be approximately 1/2 inch above the larger opening of the channel.

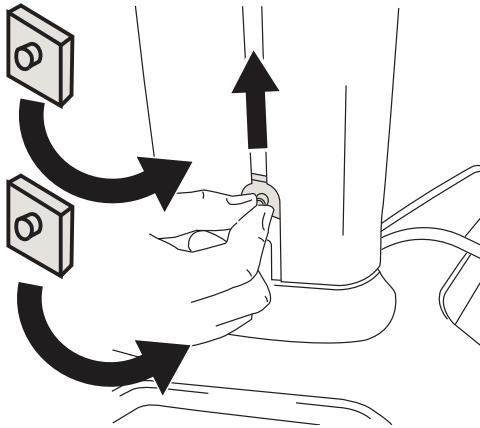

2. Place the top of the battery compartment to the top nut pad sliding it up to the mark. Slide to adjust until the bottom screw hole catches on the bottom nut pad. Use the 4 mm hex to first tighten the top M5 x 9 mm screw and then the bottom screw.

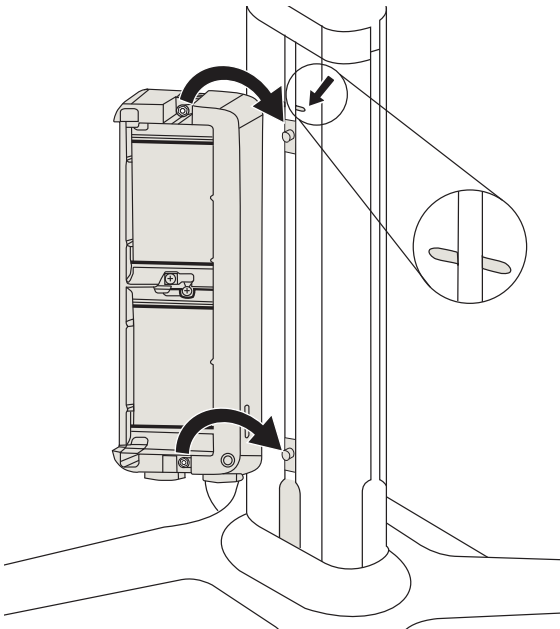

3. Plug the black power supply cable into the right-hand connector and the silver tipped power supply cable into the left-hand connector making sure the pins line up in the back towards the stand column. Twist the covers clockwise to tighten.

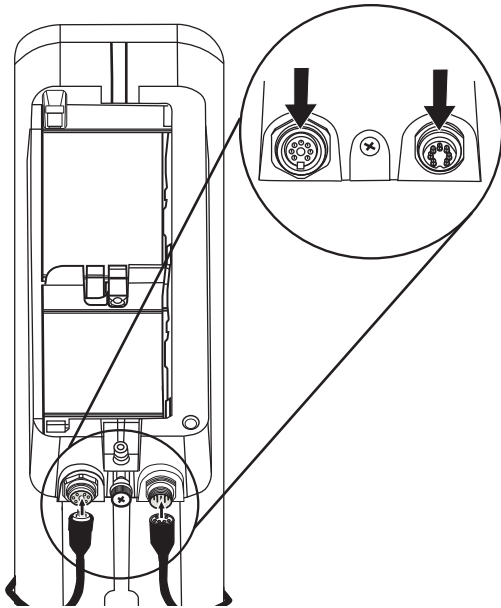

If you do not have the optional stand battery, plug the connectors into each other and store under the column base cover.

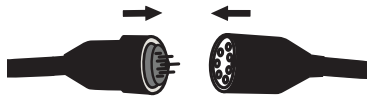

4. Place each of the 2 batteries into the compartments with the connectors inserted into the upper right-hand recess and snap into place.

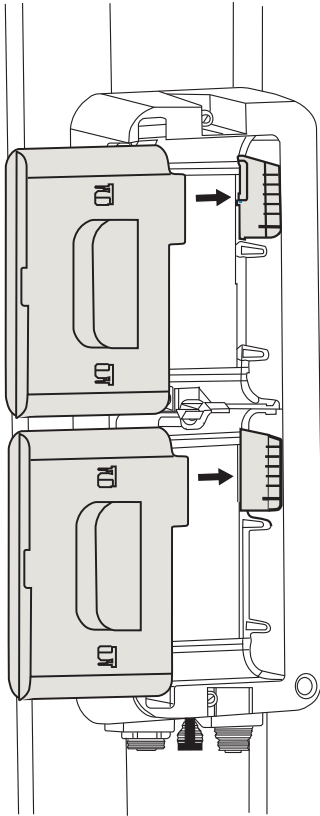

5. Place the battery cover over the battery compartment.

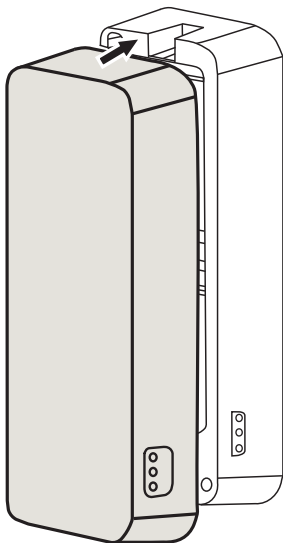

6. Secure the screw at the bottom of the battery cover by pushing it up and turning it clockwise.

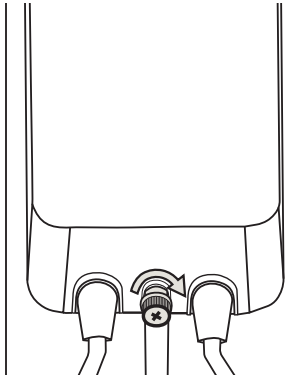

7. To replace the stand batteries, remove the battery cover and old batteries by reversing the previous three steps.
8. When you are done installing any optional accessories with cables, place the column base cover around the bottom of the stand column by pulling it apart slightly at the side opening. Click into place in the stand base opening.

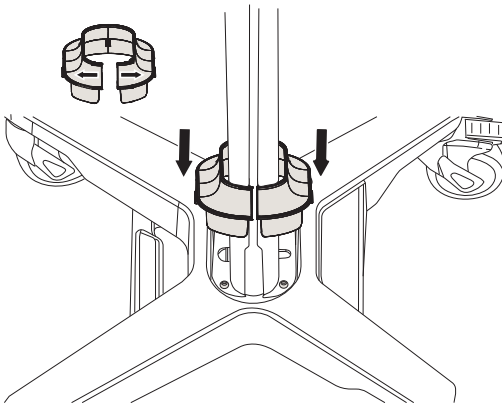

Install the system battery and connect to power

1. Unpack the system and place it down on a flat surface. The system battery is attached to the battery compartment cover.

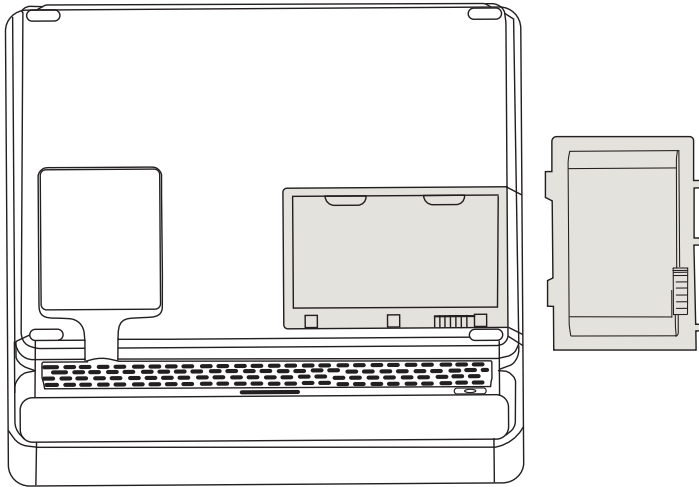

2. Insert the 3 battery enclosure tabs in the 3 compartment recesses. Press the battery compartment cover down while also pressing the latch down making sure the 2 enclosure tabs click firmly into place.

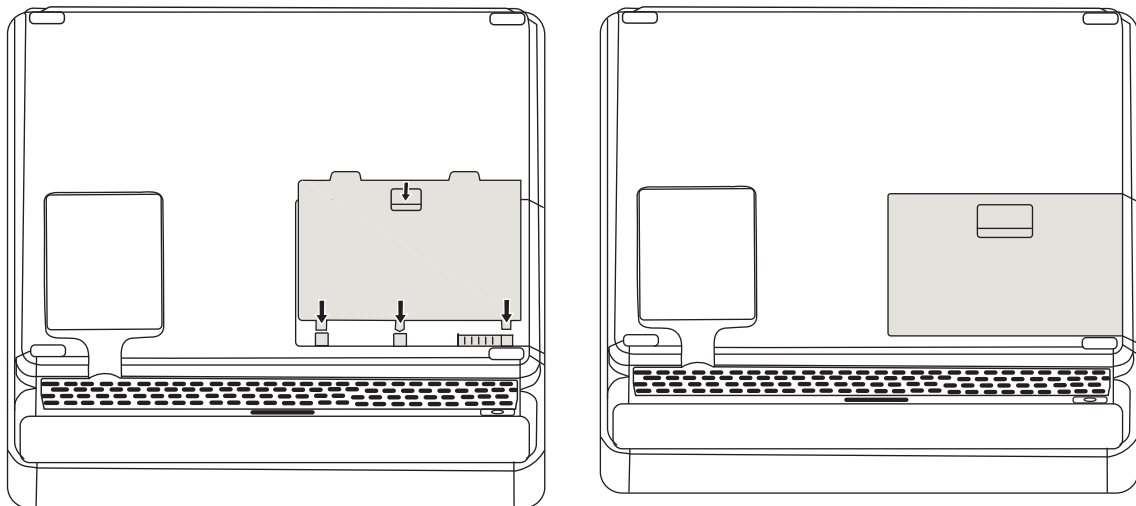

3. To connect the portable system to power, plug the power supply cable into the system connector making sure the pins line up and turn the connector covers clockwise simultaneously with both hands to secure them to each other.

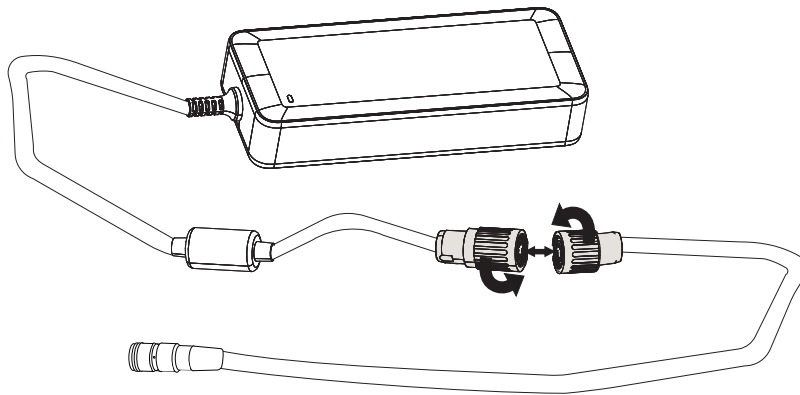

4. Plug the AC power cable into the power supply.

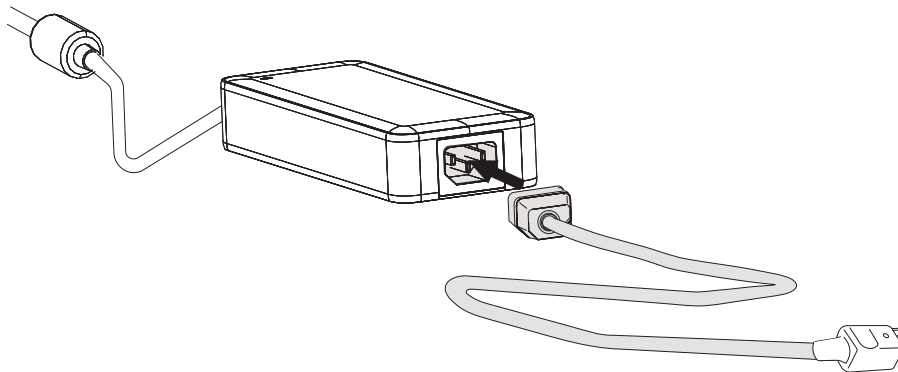

5. Connect the AC power cord to a hospital-grade AC mains outlet.

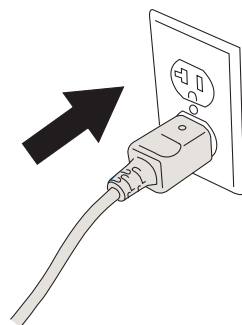

Install the optional TTC and I/O hub

1. Set the stand platform upside down on a flat surface with the handle facing away from you.
2. Place the dangling TTC connector in the recess. Set the rest of the TTC unit behind the bottom of the transducer cups using the 4 screw holes as your guide with the cable channels facing out.

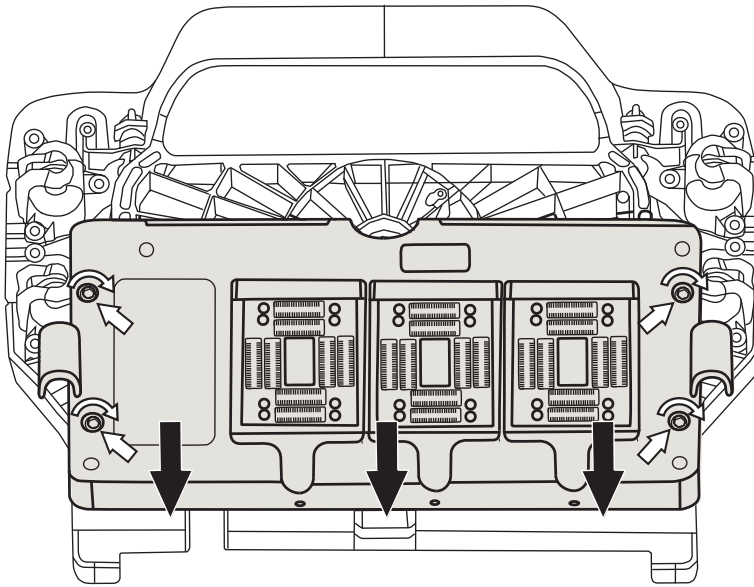

3. The TTC screws are already inside the marked screw holes. Tighten the screws with the 4 mm hex provided in the TTC installation kit.
4. Set the optional I/O hub in the channel between the 4 screw holes with the connection openings facing the stand platform handle. Insert and tighten the screws with the 4 mm hex provided in the I/O hub installation kit.

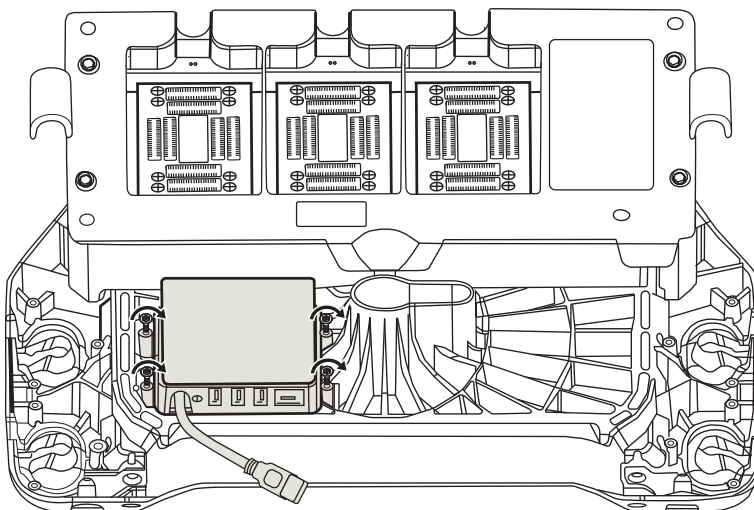

5. Holding the system handle, place the back of the system on the stand platform with the front of the system tilted up so that you can still access the TTC connector. Make sure you are

docking the system to the stand platform with the system handle at the front of the stand (opposite direction of the stand handle).

6. Reach between the system and the stand platform to connect the TTC to the system by inserting the TTC connector in the system TTC recess, rotating the latch and pressing it down.

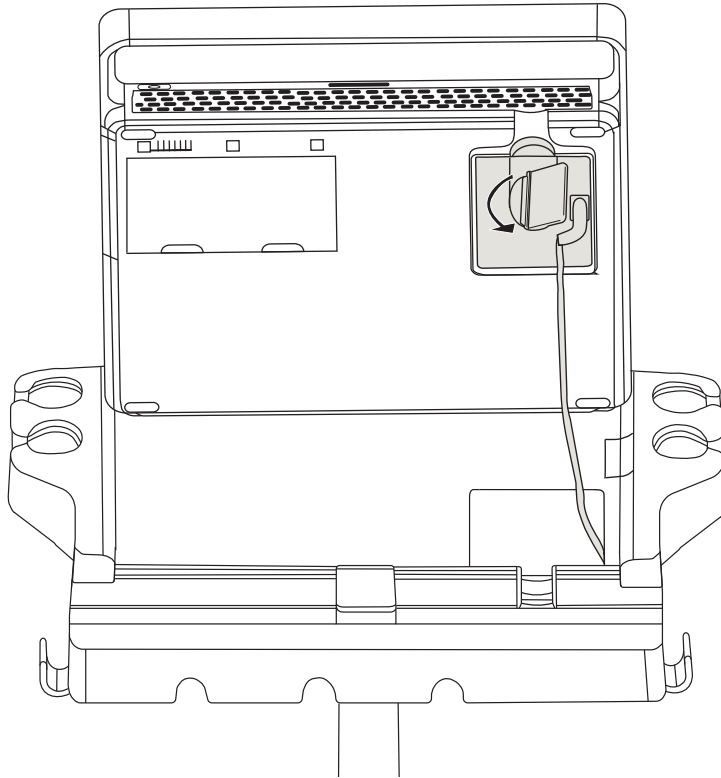

7. Secure the system by setting it system down until it clicks into place with the latch on the front of the stand platform.

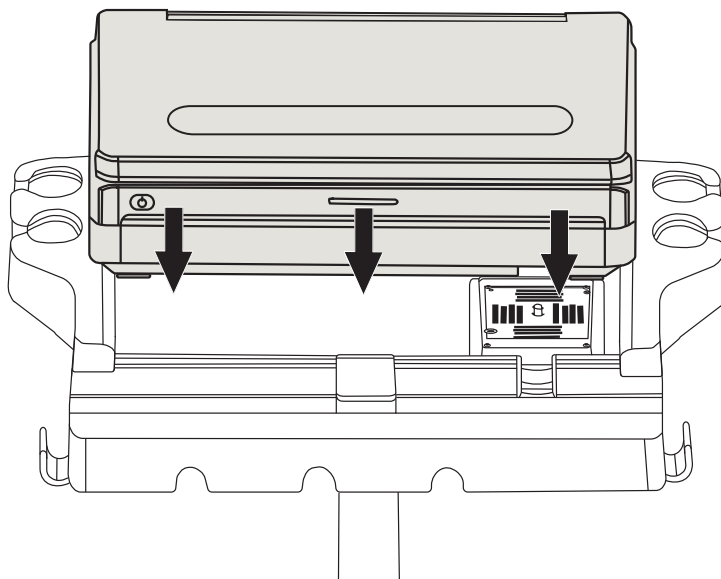

Install the stand platform

1. Install the stand platform on the stand column post by tilting it slightly towards the front of the stand. Line up the screw mechanism on the stand head with the notch on the column post.

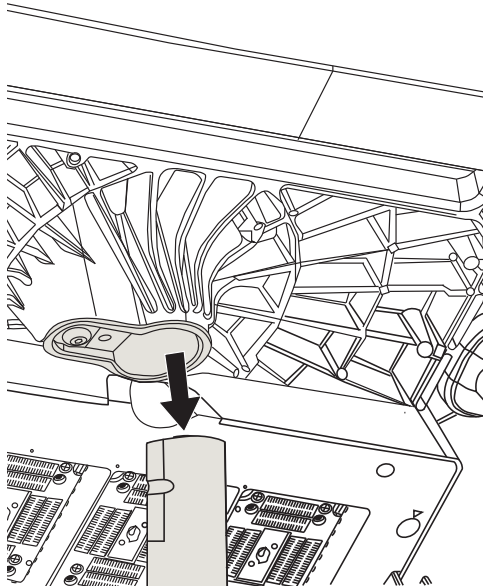

2. Make sure the stand platform is secured on the column and the screw mechanism is lined up with the column notch. Tighten the screw with the 4 mm hex by turning it clockwise.

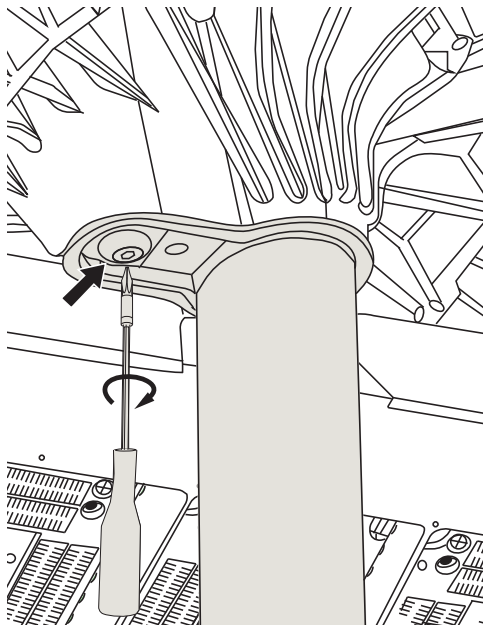

3. Connect the column power cable to the system by lining up the red dots on the power connector and receiver and pushing it into place. Tug gently to make sure it is secure.

When removing the power connector, gently pull it out by firmly grasping the textured part of the connector without twisting it excessively.

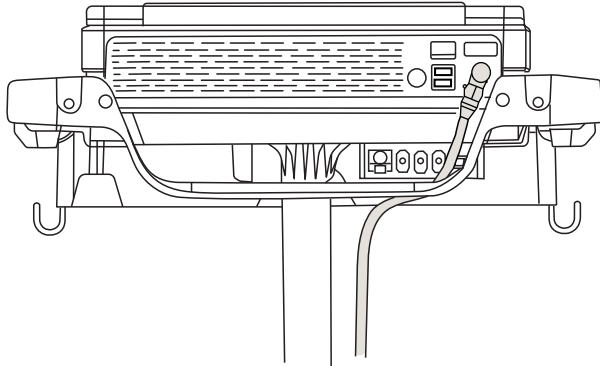

Connect the stand to power

1. Connect AC power cord from the system box to the base of the stand.

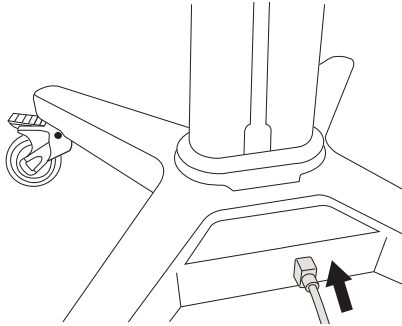

2. Run the AC power cord through the cord clip on the back of the storage tray or the cord retention hook below the storage basket. Wrap the cord if you need to wheel the system to an outlet.
3. Connect the AC power cord to a hospital-grade AC mains outlet.

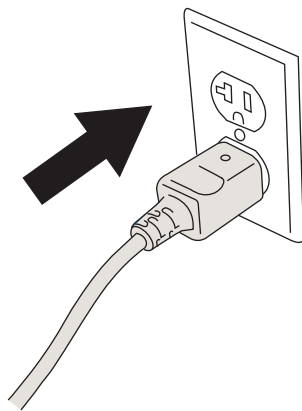

4. Allow the system to charge for 6 hours before using. This ensures the best battery life and user experience. The power status light will indicate a solid blue when fully charged.



FUJIFILM

SONOSITE

P25675-02

