

SonoSite X-Porte

Wireless Adapter Installation Instructions

Unpacking the box	1
Connecting the wireless adapter to the SonoSite X-Porte system	2
To install on a system that has a VGA extension bracket	2
To install on a system that does not have a VGA extension bracket	4
To install on a system in desktop mode	6
Technical support and customer comments	6

Unpacking the box

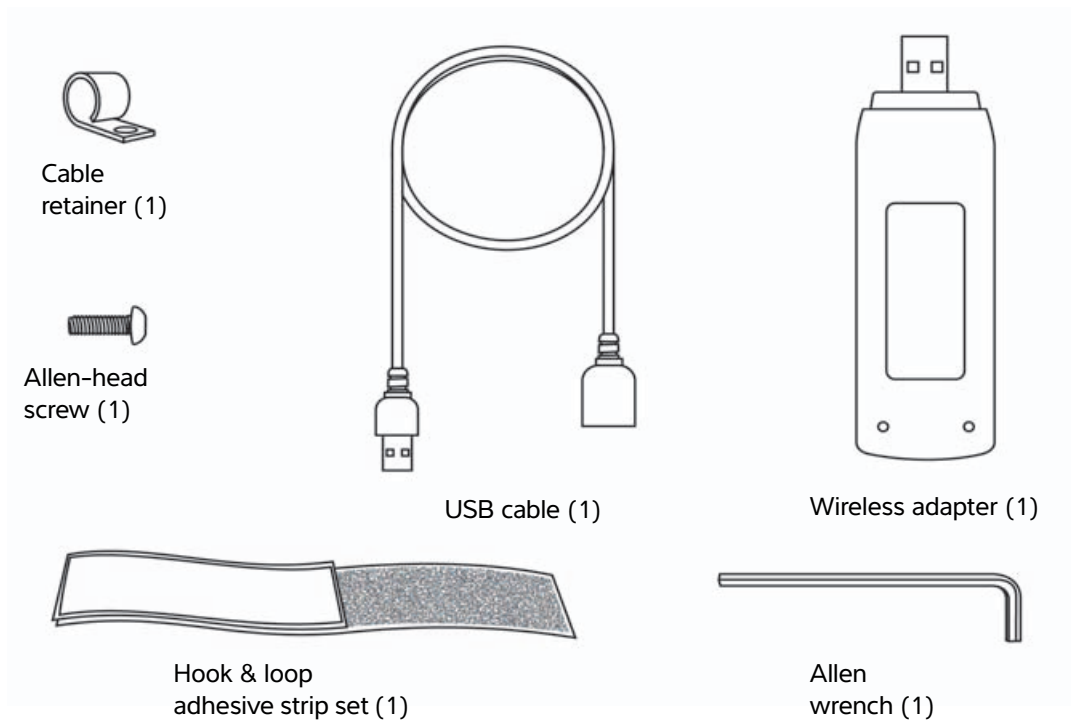

This document provides instructions for inserting and attaching the wireless adapter assembly to the SonoSite X-Porte ultrasound system.

After installation, your wireless adapter may need to be activated. To activate your wireless adapter, please contact FUJIFILM SonoSite Technical Support. For contact information, see **“Technical support and customer comments”** on page 6.

For general information about configuring wireless network access, see the *SonoSite X-Porte User Guide*.

Connecting the wireless adapter to the SonoSite X-Porte system

To install on a system that has a VGA extension bracket

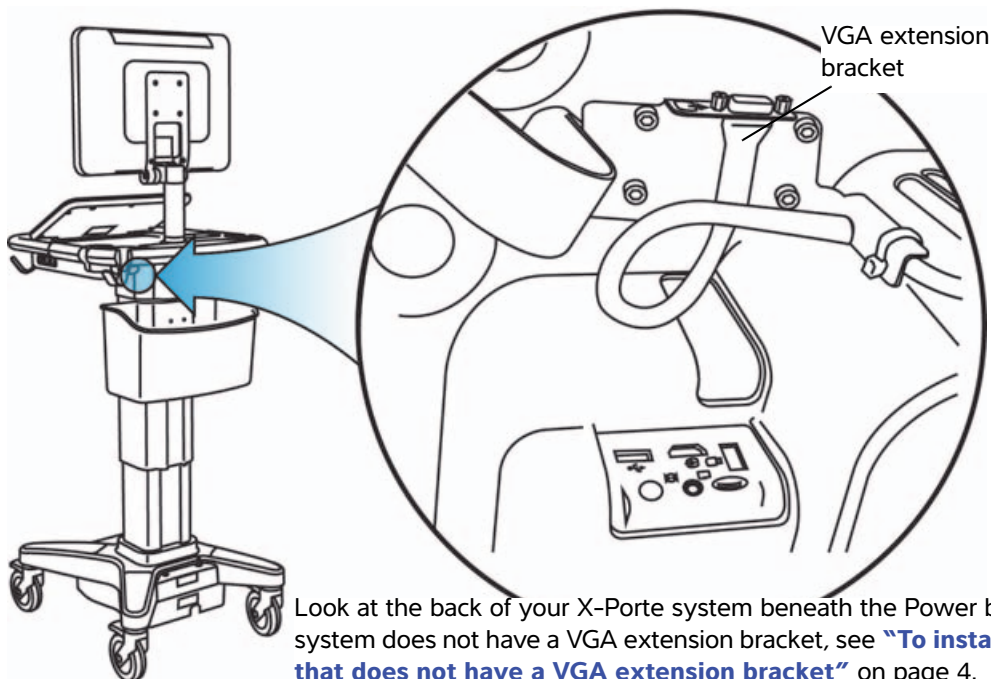

STEP 1

Route the USB cable above the video output cable.

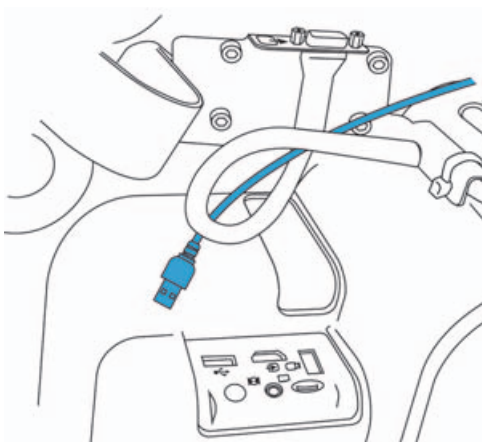

STEP 2

Insert the USB cable into a USB port on the back of the system.

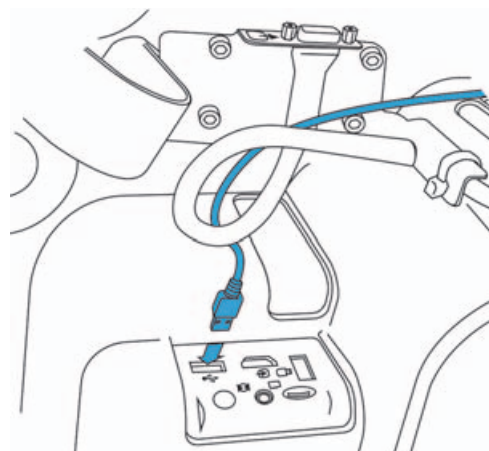

STEP 3

Remove the adhesive backing from the short side of the hook and loop strip.

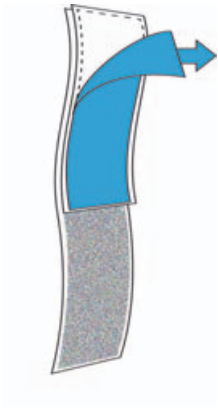

STEP 4

Attach the hook and loop strip to the wireless adapter.

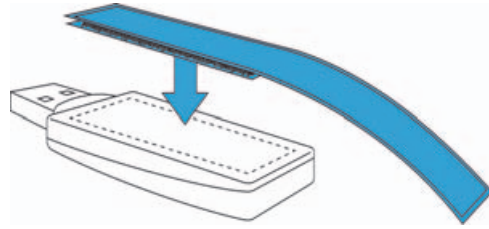

STEP 5

Plug the wireless adapter into the USB cable.

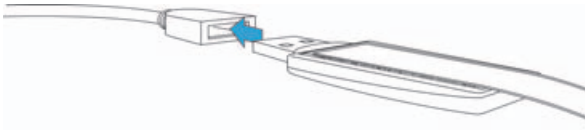

STEP 6

Remove the adhesive backing from the hook and loop strip.

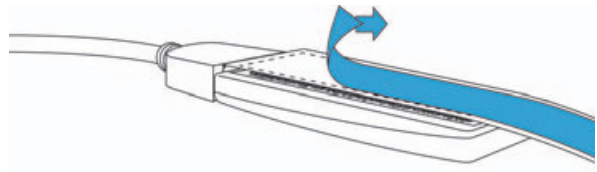

STEP 7

Attach the wireless adapter to the underside of the SonoSite X-Porte system. Press and hold the adapter in place for at least 10 seconds to ensure a strong bond.

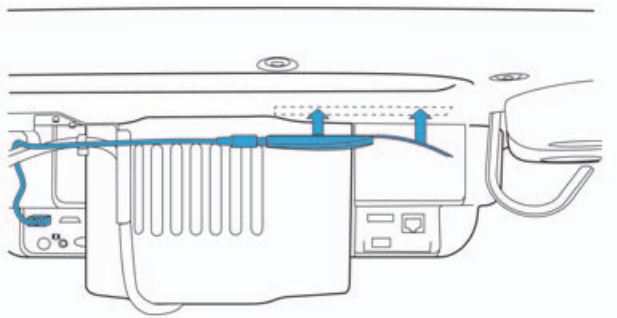

To install on a system that does not have a VGA extension bracket

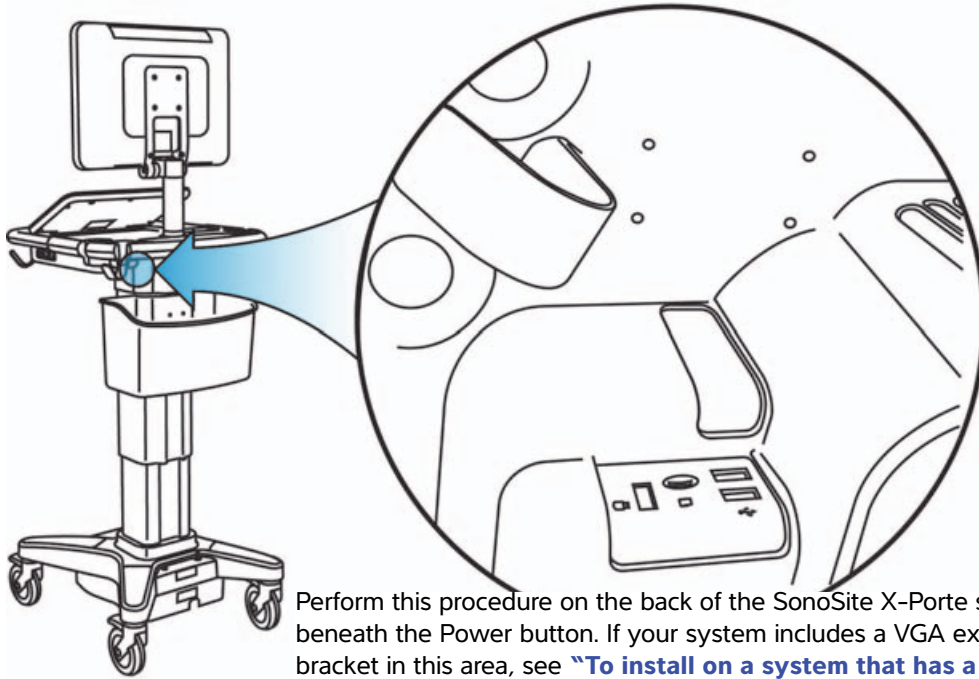

Perform this procedure on the back of the SonoSite X-Porte system beneath the Power button. If your system includes a VGA extension bracket in this area, see **"To install on a system that has a VGA extension bracket"** on page 2.

STEP 1

Fasten the cable retainer to the underside of the system using the Phillips-head screw.

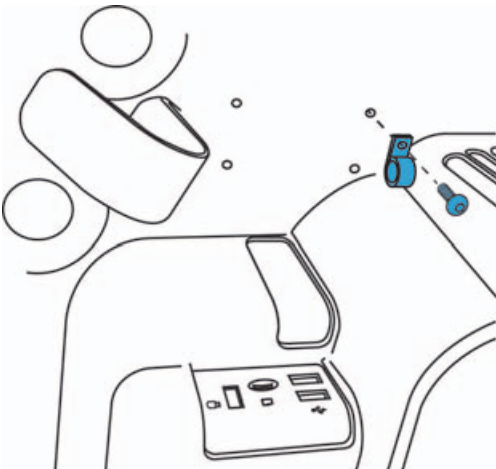

STEP 2

Insert the USB cable into a USB port on the back of the system.

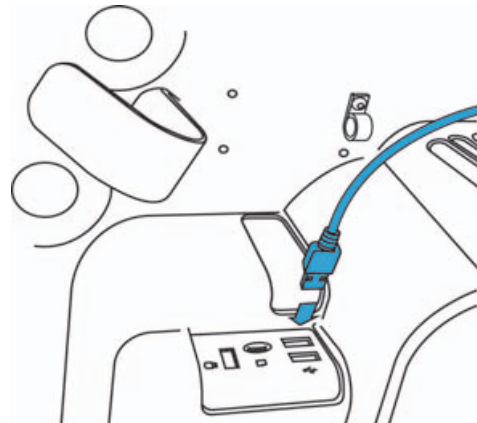

STEP 3

Insert the cable into the cable retainer.

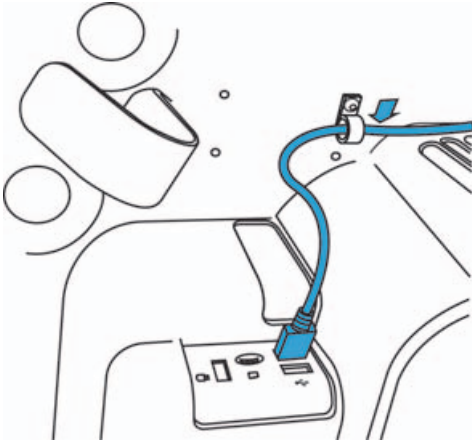

STEP 4

Remove the adhesive backing from one side of the hook and loop strip.

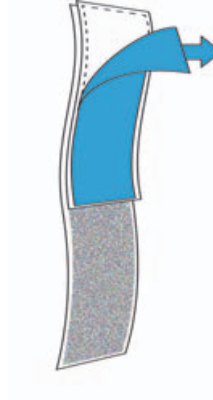

STEP 5

Attach the hook and loop strip to the wireless adapter.

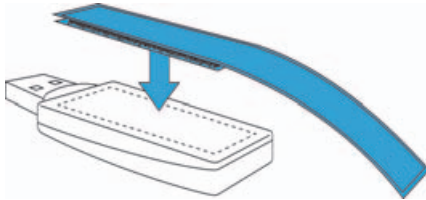

STEP 6

Plug the wireless adapter into the USB cable.

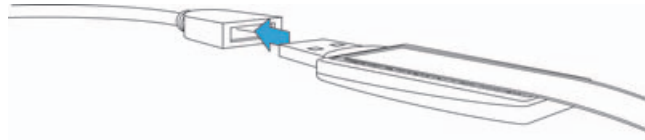

STEP 7

Remove the adhesive backing from the hook and loop strip.

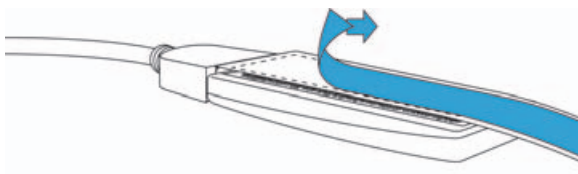

STEP 8

Attach the wireless adapter to the underside of the SonoSite X-Porte system. Press and hold the adapter in place for at least 10 seconds to ensure a strong bond.

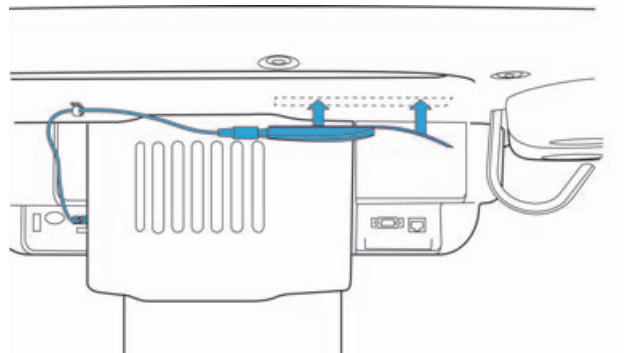

To install on a system in desktop mode

On the right side of the system, plug the wireless adapter into the rear-most of the three USB ports.

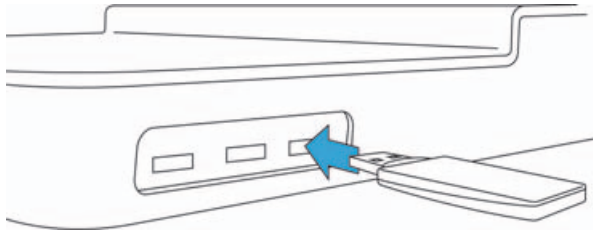

Technical support and customer comments

After installation, your wireless adapter may need to be activated. To activate your wireless adapter, please contact FUJIFILM SonoSite Technical Support.

For technical support, please contact FUJIFILM SonoSite as follows:

Phone (U.S. or Canada)	877-657-8118
Phone (outside U.S. or Canada)	425-951-1330, or call your local representative
Fax	425-951-6700
Email	ffs-service@fujifilm.com
Web	www.sonosite.com
Europe Service Center	Main: +31 20 751 2020 English support: +44 14 6234 1151 French support: +33 1 8288 0702 German support: +49 69 8088 4030 Italian support: +39 02 9475 3655 Spanish support: +34 91 123 8451

Manufacturer

FUJIFILM SonoSite, Inc.
21919 30th Drive SE
Bothell, WA 98021
USA
T: 1-888-482-9449 or 1-425-951-1200
F: 1-425-951-1201

EC Authorized Representative

Emergo Europe
Molenstraat 15
2513 BH, The Hague
The Netherlands

Australia Sponsor

FUJIFILM SonoSite Australasia Pty Ltd
114 Old Pittwater Road
BROOKVALE, NSW 2100
Australia

X-Porte, SonoSite and the SonoSite logo are registered and unregistered trademarks of FUJIFILM SonoSite, Inc. in various jurisdictions.

All other trademarks are the property of their respective owners.

Part Number: P20731-02

Publication Date: November 2016

Copyright © 2016 FUJIFILM SonoSite, Inc. All Rights reserved.



P20731-02

