

Sonosite Stand Battery Assembly Instructions

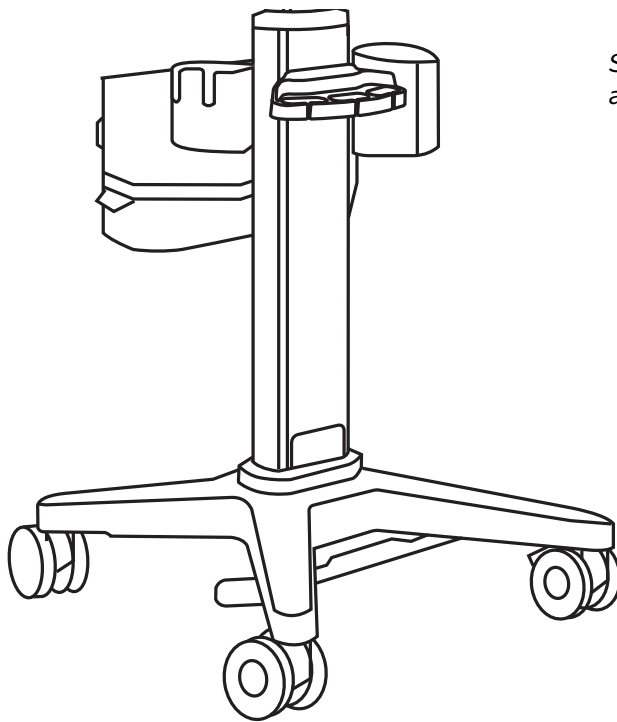

Sonosite stand with stand battery and accessories.

Inside the box

Stand Battery

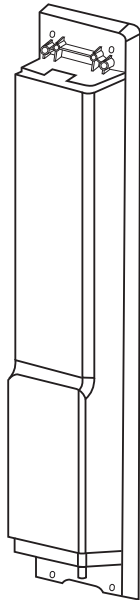

Plastic pry bar



Magnetic bit driver

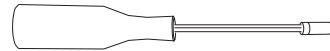

#1 Phillips bit



3 mm hex bit



Base cover

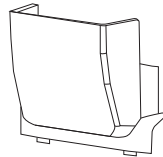

M4 x 20 mm hex socket head cap screws (4)

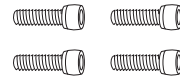

Install the Stand Battery

STEP 1

Disconnect the stand from power.

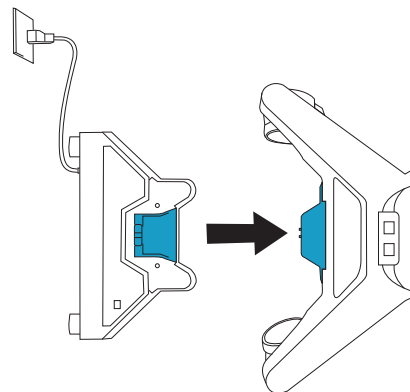
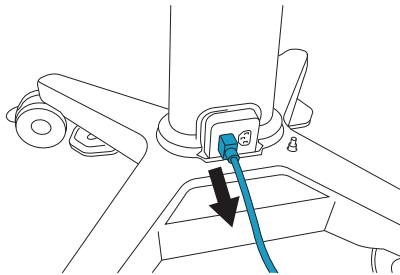

STEP 2

Lift the cover off of the cable management system.

If your system has a cover installed instead of the cable management system, use the pry tool to remove the cover and then skip to step 7.

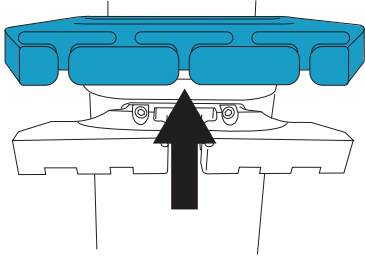

STEP 3

Use the magnetic bit driver with the #1 Phillips bit to unscrew the two screws holding the cable management bracket.

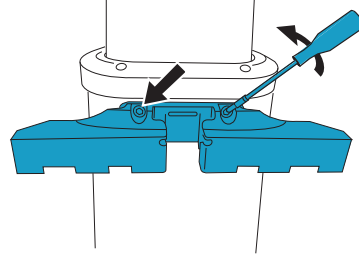

STEP 4

Pull the cable management bracket toward you to unsnap it from its mount on the stand.

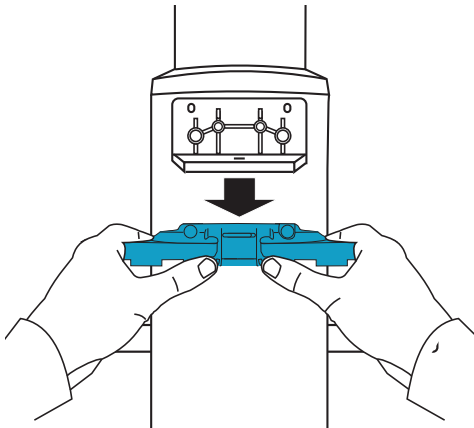

STEP 5

Use the magnetic bit driver with the 3 mm hex bit to unscrew the two screws holding the mount.

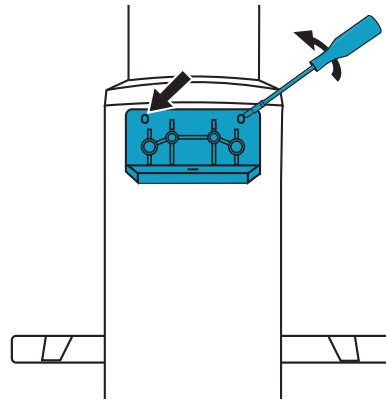

STEP 6

Remove the mount.

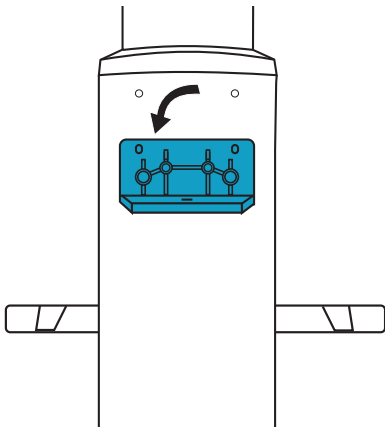

STEP 7

Use the plastic pry bar to remove the power access cover at the base of the column.

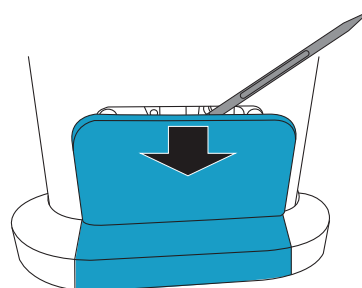

STEP 8

Gently pull out the power cable, unscrew the connectors, and disconnect them.

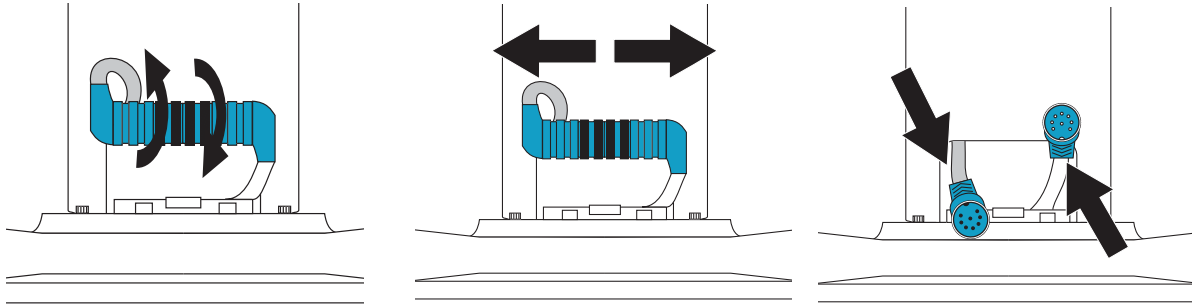

Note One option to make installation easier is to lay the stand down. To do this, first lock the rear wheels, remove the ultrasound system and all accessories, and then tilt the stand so it rests on the storage tray. Refer to the user guide for your ultrasound system for specific information.

STEP 9

Partially screw in two M4 x 20 mm screws by hand into the screw holes near the bottom of the column.

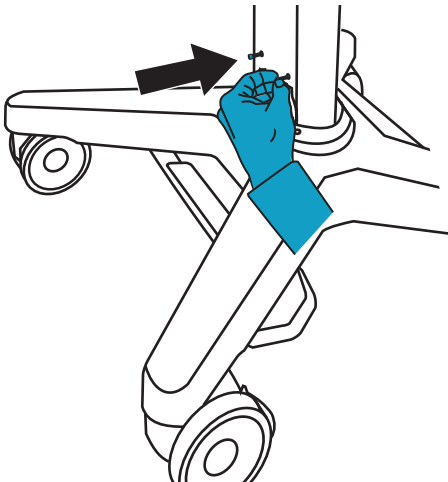

STEP 10

Slide the two screw mounts at the bottom of the stand battery over the two lower screws at the base of the stand column.

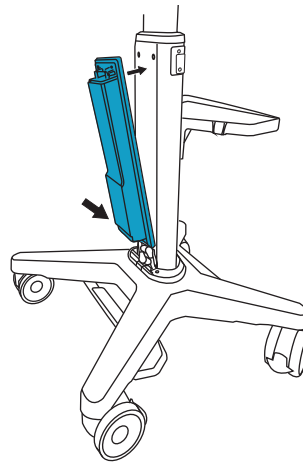

STEP 11

Use the magnetic bit driver with the 3 mm hex bit to attach the top of the stand battery to the upper holes on the stand column with two M4 x 20 mm screws, then tighten the lower screws.

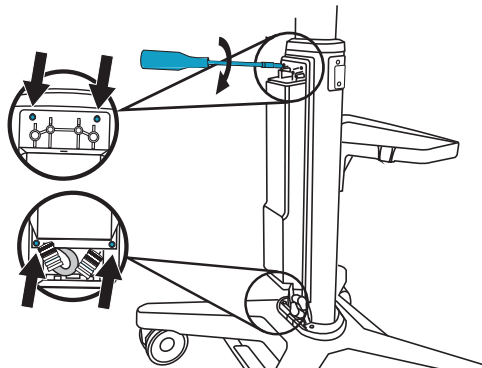

STEP 12

Align the cable connector coming up from the bottom of the stand with the corresponding connector on the bottom of the stand battery, push it into place, and then screw clockwise to tighten.

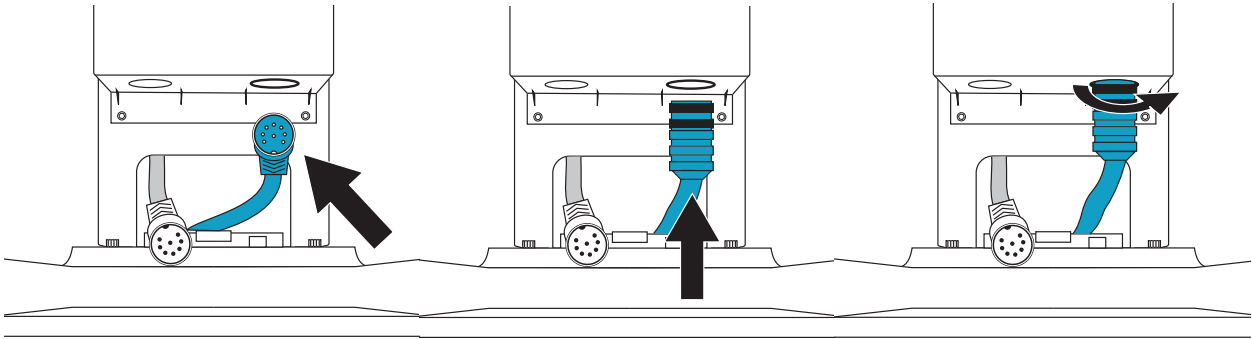

STEP 13

Align the cable connector coming from the top of the stand with the corresponding connector on the bottom of the stand battery, push it into place, and then screw clockwise to tighten.

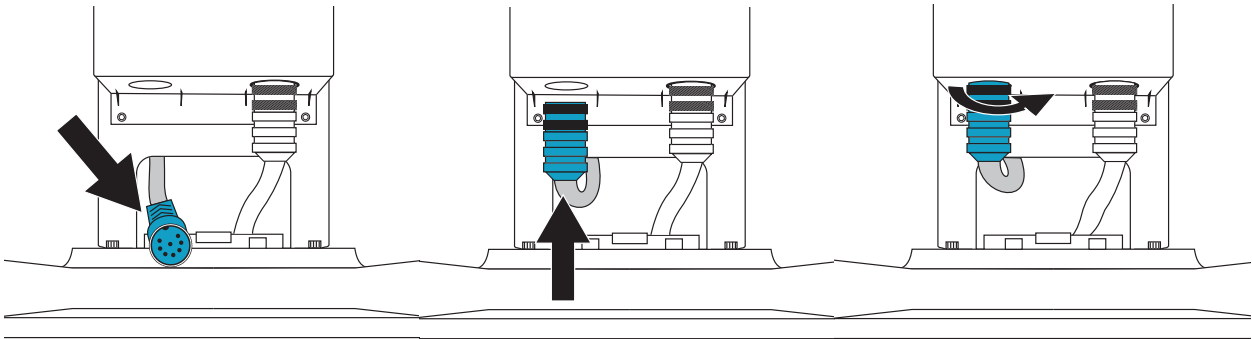

STEP 14

Set the tabs of the bottom cover into the slots in the stand base, then press it against the stand battery until it clicks into place.

If the cover doesn't snap into place easily, loosen the four screws holding the stand battery, and then slide the stand battery up slightly to provide more clearance for the cover.

After positioning the stand battery, tighten all four screws to secure the stand battery.

If you have the stand laying down, lift it back up.

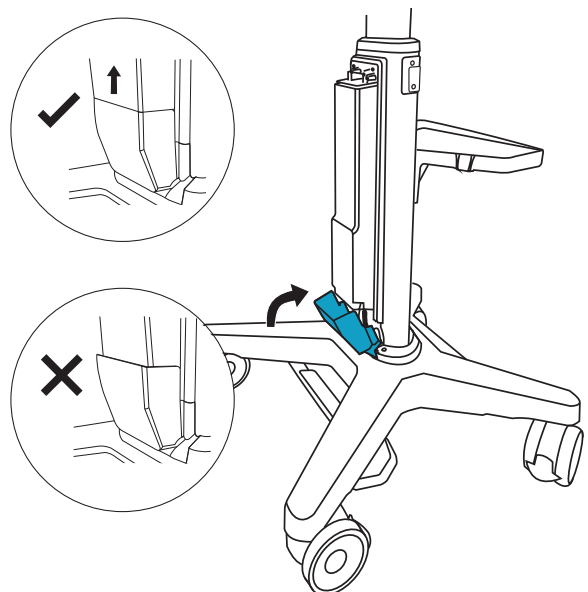

STEP 15

If available on your system, slide the cable management bracket on top of the stand battery, pressing it toward the column until it snaps into place.

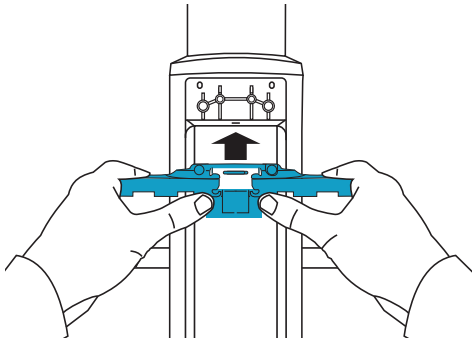

STEP 16

Re-attach the cable management bracket to the column using the bit driver with the Phillips bit.

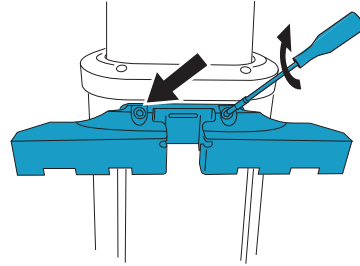

STEP 17

Press the cable management cover down over the top of the cable management bracket.

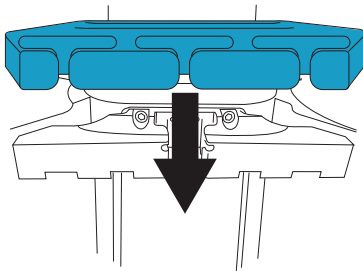

STEP 18

If removed, re-attach the ultrasound system and any accessories.

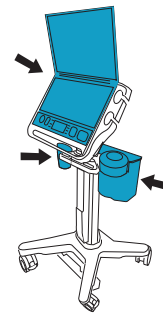

STEP 19

Connect the stand to power.

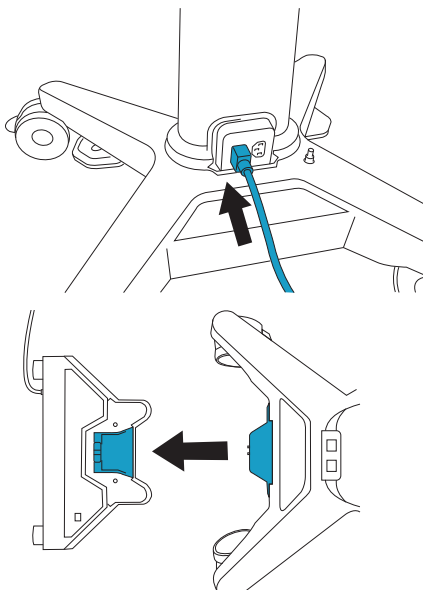

STEP 20

Make sure that the lower power status light located on the left side of the stand battery is green.

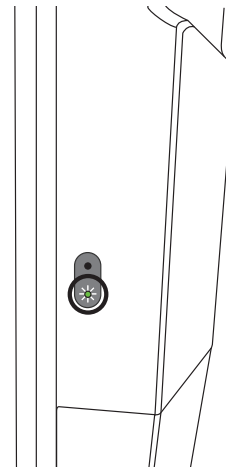

Replace the Stand Battery

STEP 1

Disconnect the stand from power.

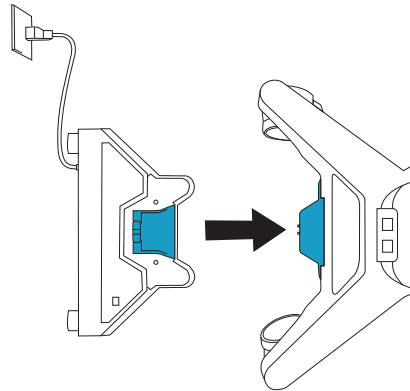
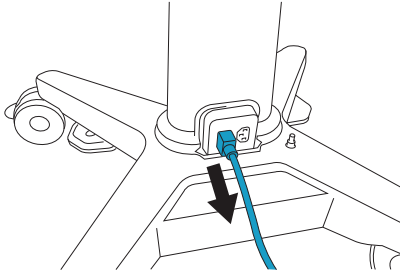

STEP 2

Lift the cover off of the cable management system.

If your system has a cover installed instead of the cable management system, use the pry tool to remove the cover and then skip to step 7.

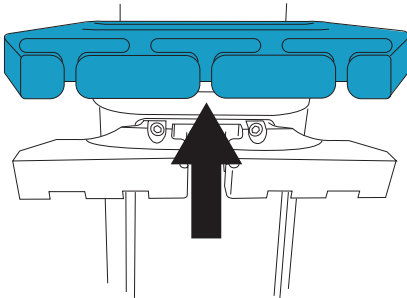

STEP 4

Pull the cable management bracket toward you to unsnap it from its mount on the stand.

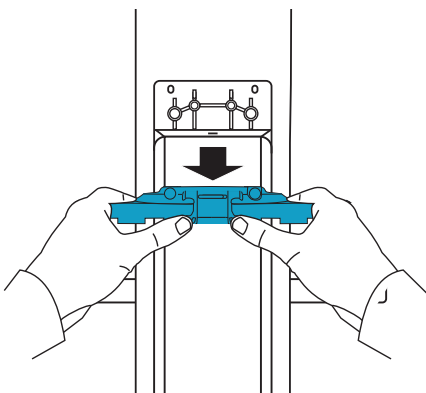

STEP 3

Use the magnetic bit driver with the #1 Phillips bit to unscrew the two screws holding the cable management bracket.

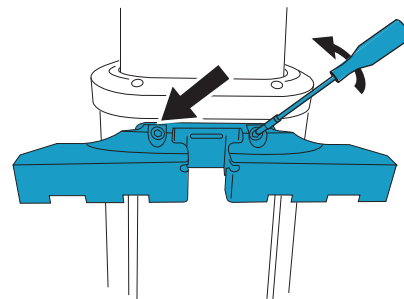

STEP 5

Use the plastic pry bar to remove the stand battery base cover.

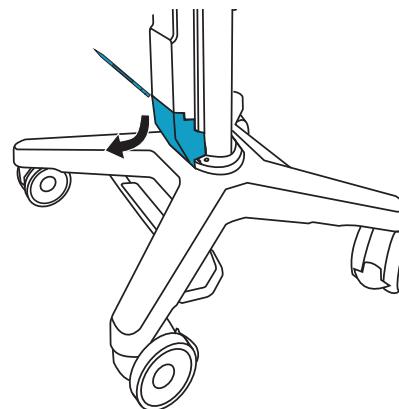



Note One option to make replacement easier is to lay the stand down. To do this, first lock the rear wheels, remove the ultrasound system and all accessories, and then tilt the stand so it rests on the storage tray.

STEP 6

Pull the cable management bracket toward you to unsnap it from its mount on the stand.

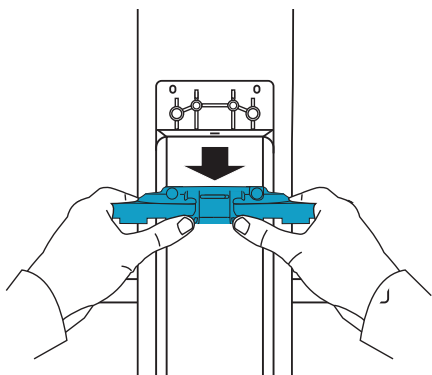

STEP 7

Use the plastic pry bar to remove the stand battery base cover.

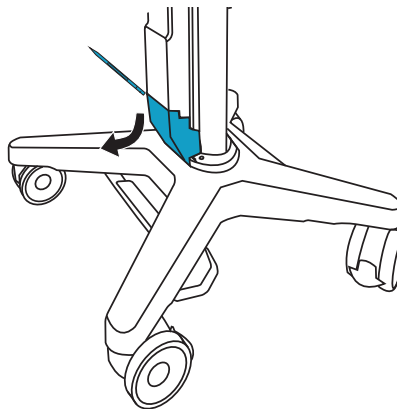

STEP 8

Unscrew the two power cables from the stand battery.

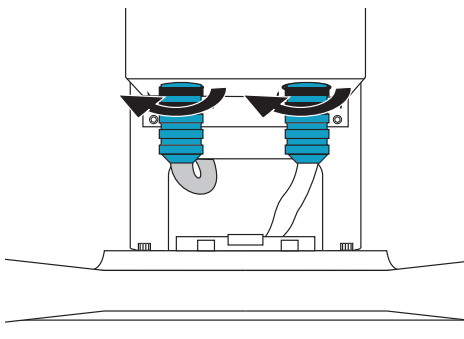

STEP 9

Pull the connectors straight down and away from the battery.

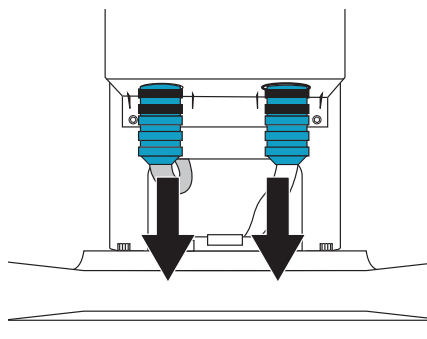

STEP 10

Use the magnetic bit driver with the 3 mm hex bit to remove the two screws at the top of the stand battery, then loosen the two lower screws while holding the top of the stand battery.

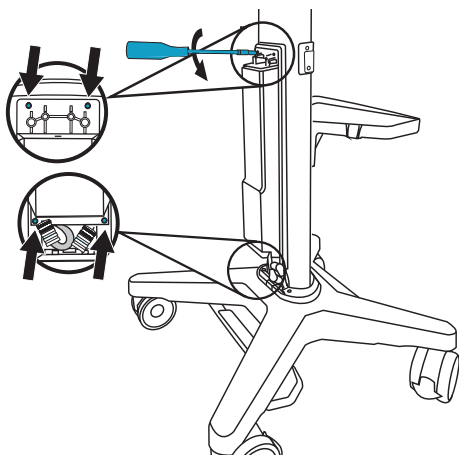

STEP 11

Remove the stand battery off of the stand column.

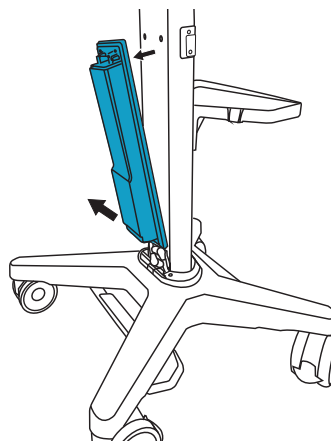

STEP 12

Slide the two screw mounts at the bottom of the new stand battery over the two lower screws at the base of the stand column.

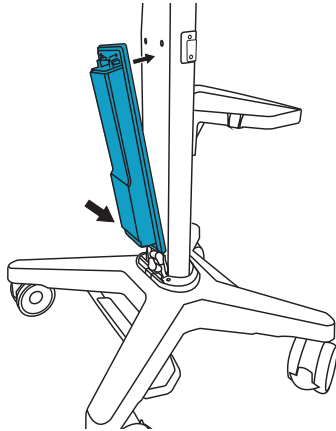

STEP 13

Use the magnetic bit driver with the 3 mm hex bit to attach the top of the stand battery to the upper holes on the stand column with two M4 x20 mm screws, then tighten the lower screws.

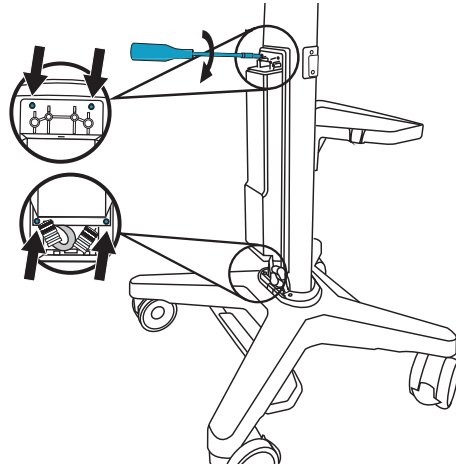

STEP 14

Align the cable connector coming up from the bottom of the stand with the corresponding connector on the bottom of the stand battery, push it into place, and then screw clockwise to tighten.

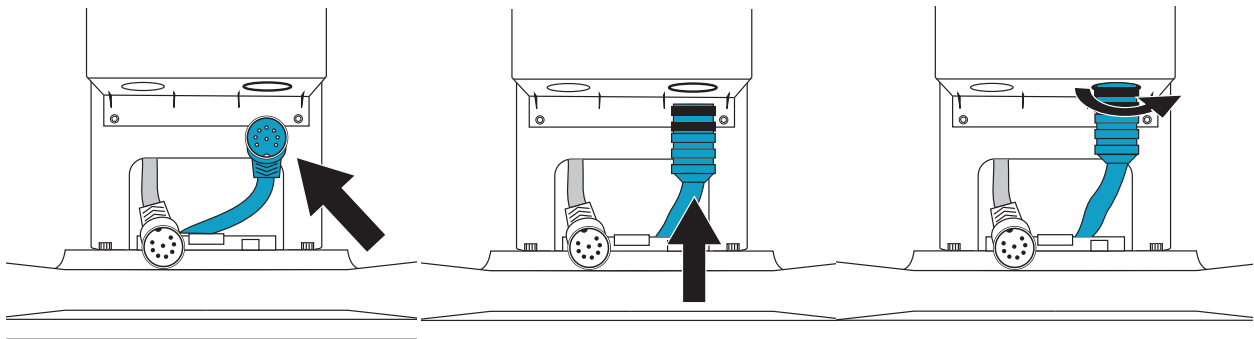

STEP 15

Align the cable connector coming from the top of the stand with the corresponding connector on the bottom of the stand battery, push it into place, and then screw clockwise to tighten.

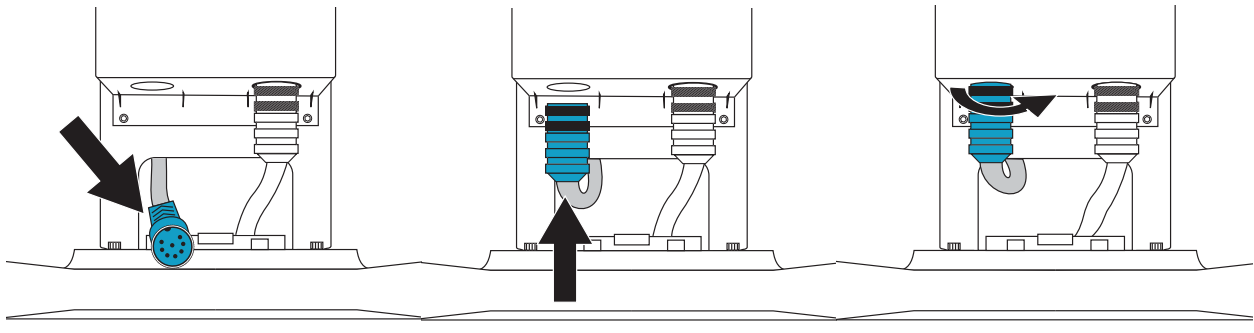

STEP 16

Set the tabs of the bottom cover into the slots in the stand base, then press it against the stand battery until it clicks into place.

If the cover doesn't snap into place easily, loosen the four screws holding the stand battery, and then slide the stand battery up slightly to provide more clearance for the cover.

After adjusting the stand battery position, tighten all four screws.

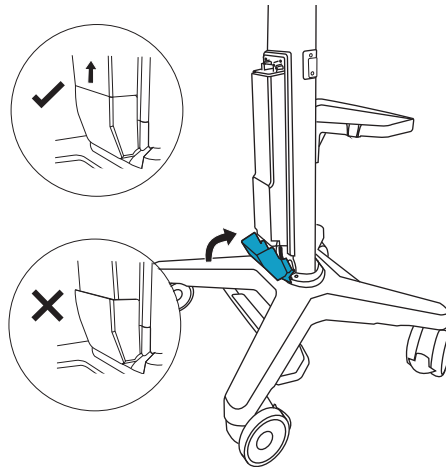

STEP 17

Slide the cable management bracket into position on top of the stand battery. Press it toward the column until it snaps into place.

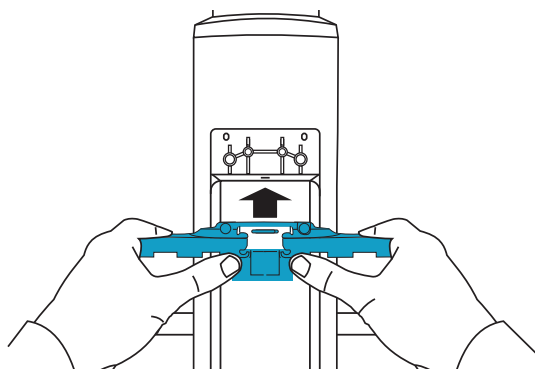

STEP 19

Press the cable management cover down over the top of the cable management bracket.

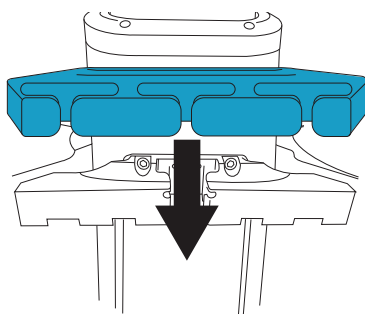

STEP 18

Re-attach the cable management bracket to the column using the bit driver with the Phillips bit.

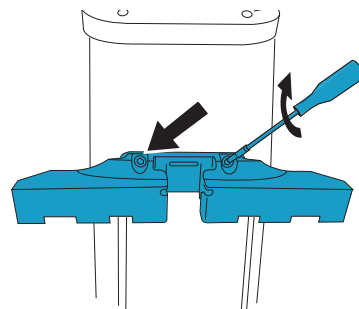

STEP 20

SONOSITE is a registered trademark of FUJIFILM SonoSite, Inc. in various jurisdictions. FUJIFILM is a registered trademark of FUJIFILM Corporation. Value from Innovation is a trademark of FUJIFILM Holdings America Corporation.

All other trademarks are the property of their respective owners.

Published July 2021

Copyright © 2021 FUJIFILM SonoSite, Inc. All rights reserved.

Manufacturer

FUJIFILM SonoSite, Inc.
21919 30th Drive SE
Bothell, WA 98021 USA
T: 1-888-482-9449 or
1-425-951-1200
F: 1-425-951-1201

**EC Authorized
Representative**

FUJIFILM SonoSite B.V.
Joop Geesinkweg 140
1114 AB Amsterdam,
The Netherlands

Australia Sponsor

FUJIFILM SonoSite Australasia Pty Ltd
114 Old Pittwater Road
BROOKVALE, NSW, 2100
Australia



P23650-02

