

SonoSite SII

Stand Assembly Instructions

FUJIFILM
Value from Innovation

SonoSite

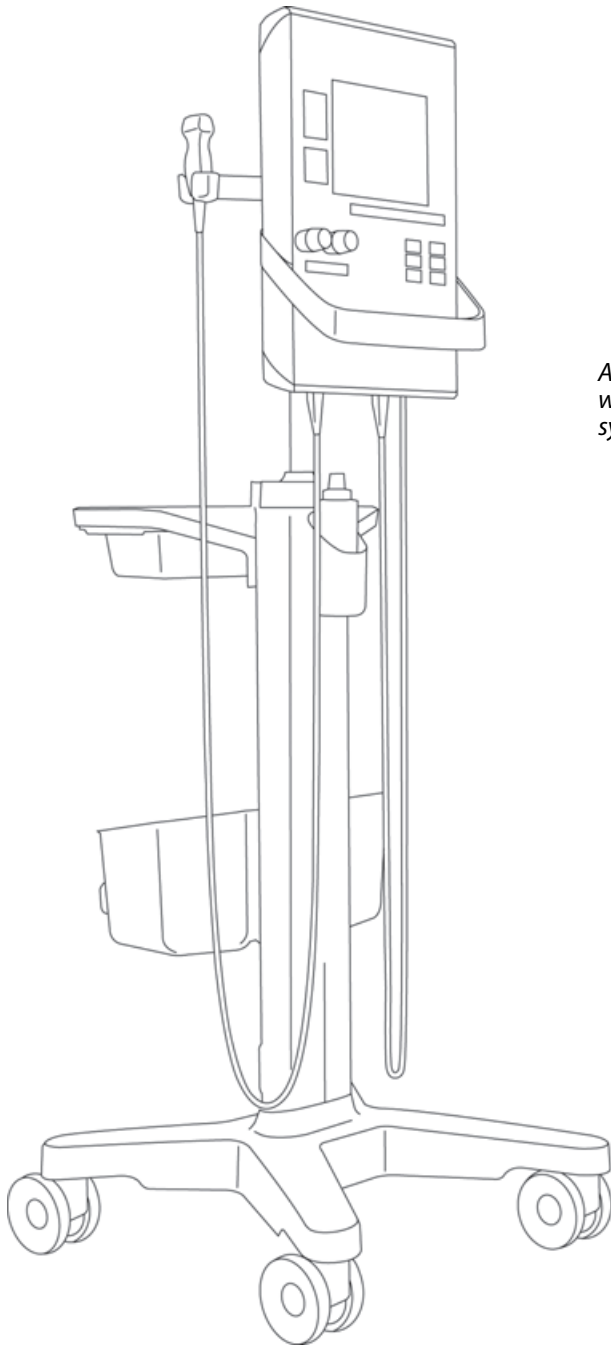

*Assembled SonoSite SII Stand
with SonoSite SII ultrasound
system.*

Unpacking the box

Column (1)



Base (1)

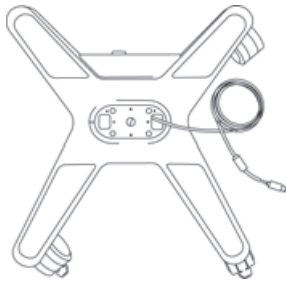

T-handle wrench (1)



4 mm Allen bit (1)



Phillips-head bit (1)



Storage bin (1)

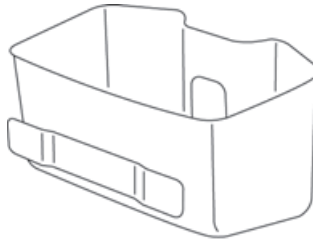

12 mm Allen-head screw (4)



Storage bin mounting bracket (preinstalled) (1)

Cord catch (preinstalled) (4)



14 mm Allen-head screw (2)



Transducer holder (1)

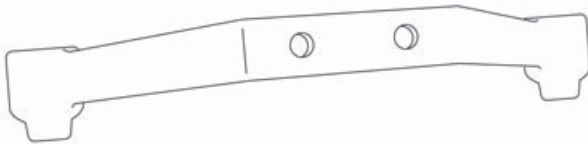

Washers (2)



Column channel nut plates (preinstalled) (2)

Tray assembly with drawer (1)



Gel bottle holder (1)

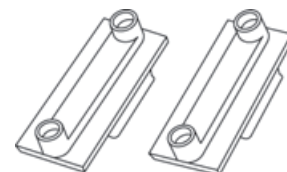

Preparing the stand

STEP 1

Press down on the locking lever on two or more wheels.

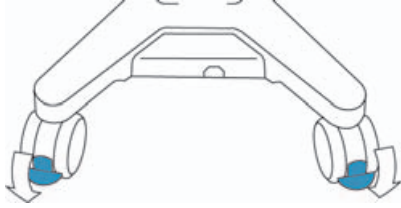

Attaching the column to the base

STEP 2

Place the column in the two pegs by aligning the two pin holes in the column with the two pin holes in the base.

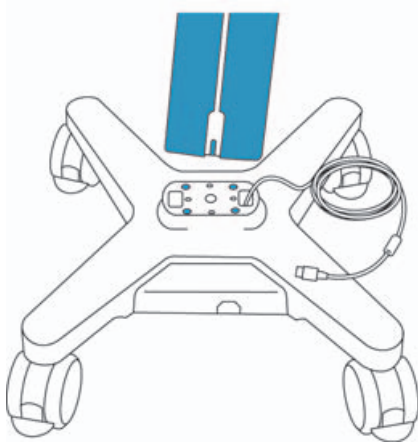

STEP 3

Insert the Allen bit into the T-handle wrench.

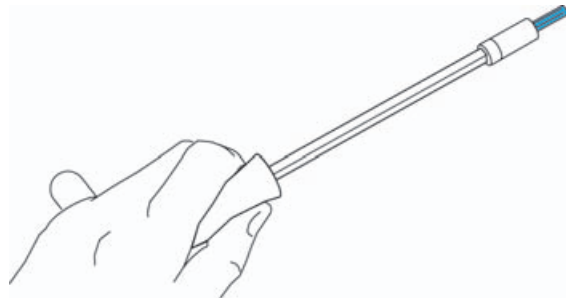

STEP 4

Place a 12 mm Allen-head screw on the T-handle wrench, and tighten the screw on the front of the column.

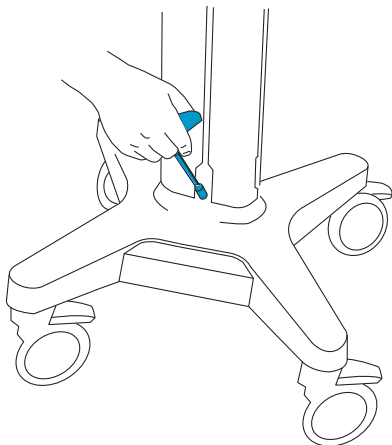

STEP 5

Repeat Step 4 with the other three 12 mm Allen-head screws on the back and sides of the column.

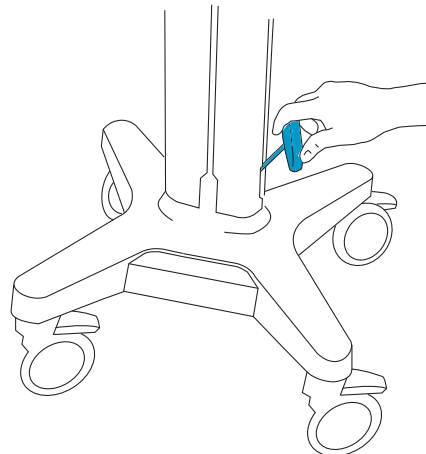

Positioning the DC power supply cord

STEP 6

Turn cord catches counter-clockwise, and pull them away from the column sides.

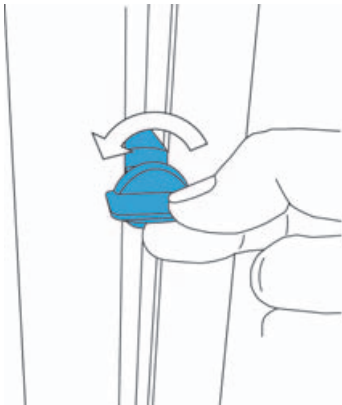

STEP 7

Slide the cord through the slot on the side of the column so that the cord extends out of the top of the slot.

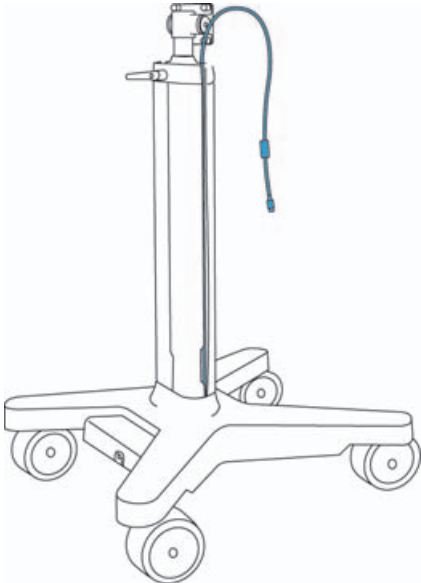

STEP 8

Insert the cord into one of the slots in the wiring retainer bracket.

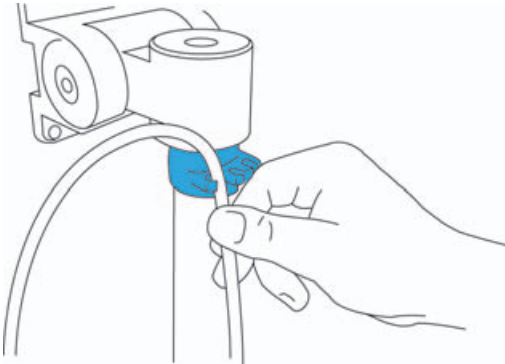

STEP 9

Screw in the cord catch screws, one higher and another lower on both sides, to retain the cord in the slots.

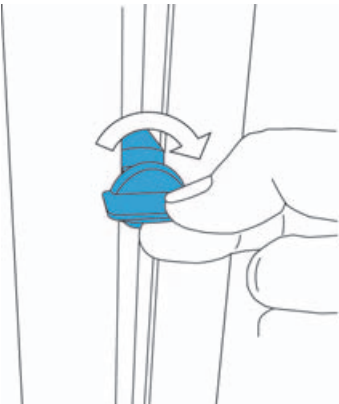

Attaching the storage bin

STEP 10

Attach the storage bin to the preinstalled mounting bracket

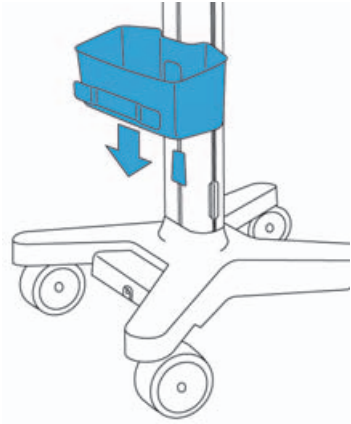

Attaching the tray assembly

STEP 11

Position the nut plate at the desired tray height.

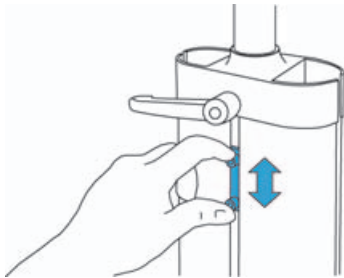

STEP 12

Attach the tray to the nut plate using two 14 mm Allen-head screws and two washers.

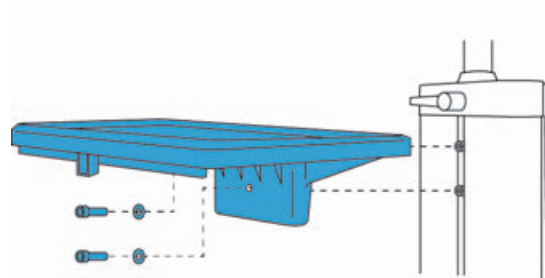

STEP 13

Using the T-handle wrench, tighten the screws.

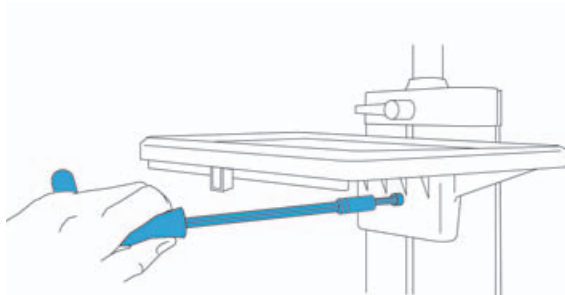

STEP 14

Slide the drawer into the slots on the underside of the tray.

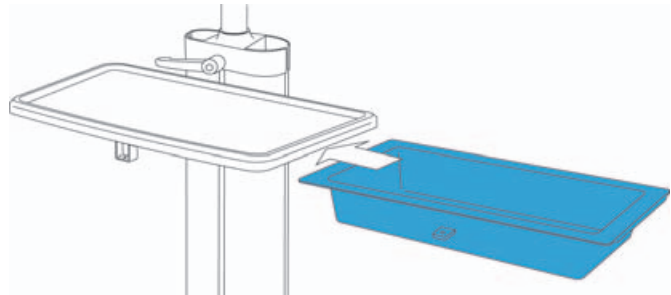

Attaching the bottle holder

STEP 15

Slide the gel bottle holder down onto the preinstalled mount.

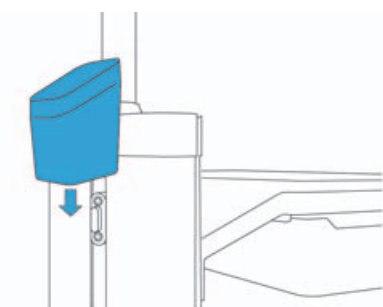





Connectivity

For information about attaching the SonoSite SII ultrasound system, see the *SonoSite SII Stand User Guide*.

WARNING: To avoid the risk of a shock hazard, do not plug the power cord of the SonoSite SII stand into an extension cord or a multiple portable socket outlet (MPSO).

Caution: To avoid damaging the system, use only peripherals recommended by FUJIFILM SonoSite with the ultrasound system.

Cables and connectors

Cable	Connector 1	Connector 2
<i>[Letter]</i>	<i>[Illustration]</i>	<i>[Illustration]</i>
<i>[Name]</i>	<i>[Connects to]</i>	<i>[Connects to]</i>
<i>[Length]</i>		
<i>[Illustration]</i>		
A DC power supply cord 6.8 ft./2 m n/a	 System or mini-dock	Preinstalled
J AC power cord 39 in./1 m n/a	 Printer	Preinstalled
K System AC power cord 10 ft./3 m	 AC adapter 1 on stand base	 Wall outlet
		

Caution: Federal (United States) law restricts this device to sale by or on the order of a physician.

SonoSite, and the SonoSite logo are trademarks or registered trademarks of FUJIFILM SonoSite, Inc. in various jurisdictions.

All other trademarks are the property of their respective owners.

Published January 2016

Copyright © 2016 FUJIFILM SonoSite, Inc. All rights reserved.

Manufacturer

FUJIFILM SonoSite, Inc.
21919 30th Drive SE
Bothell, WA 98021 USA
T: 1-888-482-9449 or 1-
425-951-1200
F: 1-425-951-1201

EC Authorized Representative

Emergo Europe
Molenstraat 15
2513 BH, The Hague
The Netherlands

Australia Sponsor

FUJIFILM SonoSite
Australasia Pty Ltd
114 Old Pittwater Road
BROOKVALE, NSW, 2100
Australia



P20558-01

