

# PowerPack

## Assembly Instructions

The PowerPack installs on either the H-Universal™ or V-Universal™ stand.

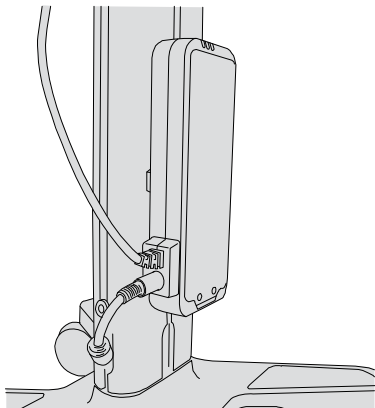
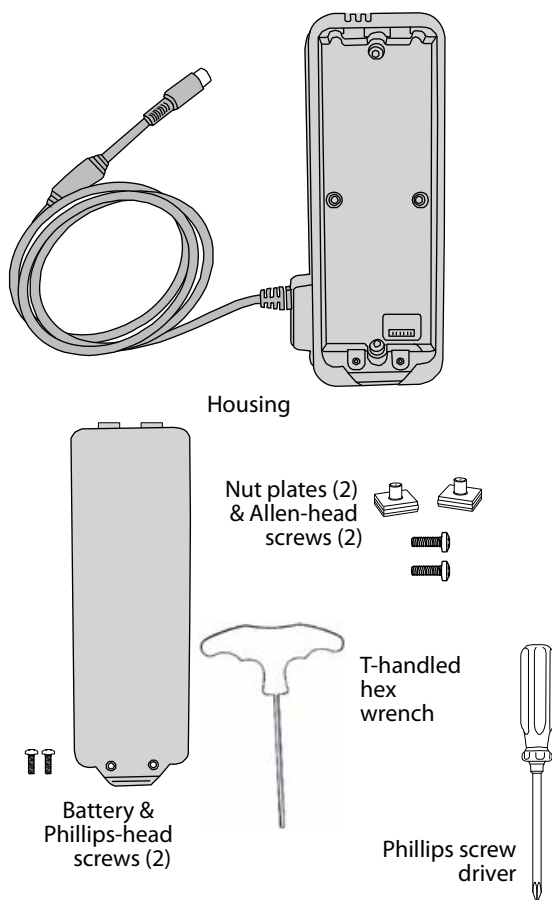

Figure 1 Installed PowerPack (vertical installation on back of stand)

## Contents



## Assembly

### 1 Determine orientation and placement.

- 1 Determine the optimal orientation for installing the PowerPack (See [Figure 4](#)):
  - **Vertical** orientation is recommended and helps protect the PowerPack from possible impact.
  - **Horizontal** orientation is acceptable if other accessories are present, providing insufficient space for vertical installation.
- 2 Determine which side of the column on which to install the PowerPack: **front** or **back**.  
Back installation may help protect the PowerPack, but consider issues such as cord placement (See [Figure 7](#)) and available space on the column.

### 2 Insert nut plates on stand.

- 1 Insert a nut plate into the groove at the lower back (or lower front, for front installation) of the stand column, and slide it a few inches up the column. See [Figure 2](#) and [Figure 3](#).  
The flat, rubber side of the plate faces toward the column.

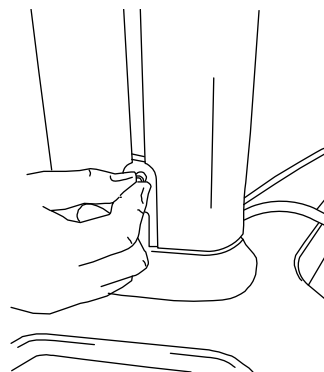

Figure 2 Insert nut plate

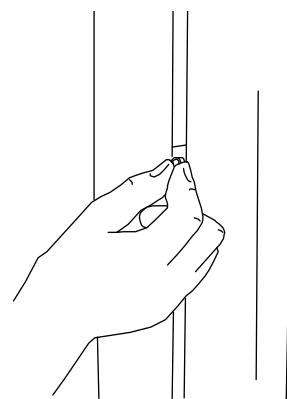

Figure 3 Slide nut plate up the column.

- 2 Insert the second nut plate, and slide it up the column.
- 3 Space the nut plates so that they align with the two holes on the housing. (See [Figure 4](#).)

### 3 Attach housing to stand.

- 1 Place the housing against the stand, inserting the nut plates into the two holes on the housing. (See [Figure 4.](#))
- 2 Secure the housing: Using the hex wrench, tighten an Allen-head screw in each of the two nut plates.

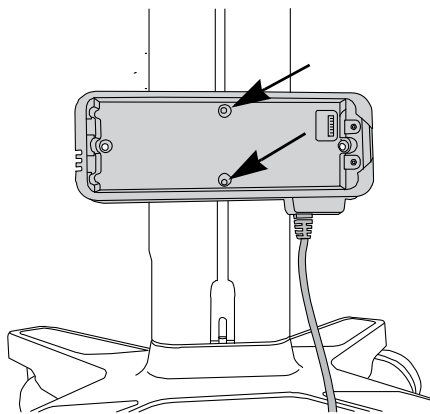
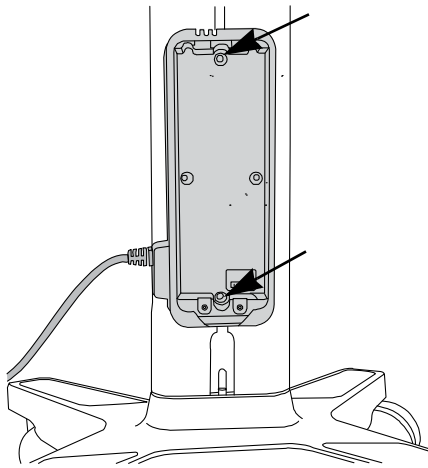

Figure 4 Tighten the 2 screws: Vertical installation (top) and horizontal installation (bottom)

### 4 Insert the battery.

**WARNING:** To avoid injury to the operator and to prevent damage to the ultrasound system, inspect the battery for leaks prior to installing.

To avoid the risk of electrical shock, do not touch the battery contacts on the PowerPack battery or housing.

- 1 Slide the tabs on the battery into the slots on the housing, and then press the opposite end of the battery into place.

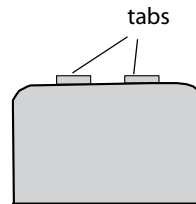

Figure 5 Tabs on battery

- 2 Insert the two Phillips-head screws into the mounting holes at the base of the battery and tighten using the Phillips screwdriver.

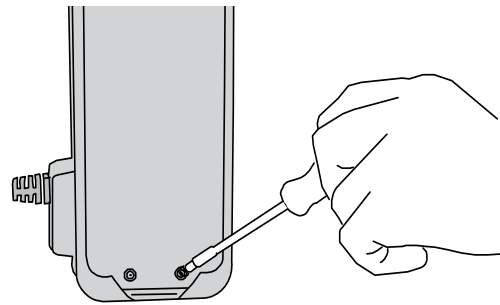

Figure 6 Tighten 2 screws on battery

### 5 Connect cables.

- 1 Connect the following cables:
  - Power supply DC power cord (**A**) from the stand to the PowerPack. (See [“Cables and connectors”](#) on page 3.)
  - PowerPack DC power cord (**Z**) to the system directly, to the NanoMaxx dock, or to the mini-dock.
- 2 If charging the battery, connect to AC power: Connect the system AC power cord (**K**) to the stand and a wall outlet. For more information, see the PowerPack user guide.

**WARNING:**

- To avoid the risk of electrical shock:
- Use only properly grounded equipment. Shock hazards exist if the power supply is not properly grounded. Grounding reliability can be achieved only when equipment is connected to a receptacle marked "Hospital Only" or "Hospital Grade" or the equivalent. The grounding wire must not be removed or defeated.
  - Use only accessories and peripherals recommended by SonoSite, including the power supply. Use the PowerPack only with SonoSite power supply P09823.
  - Do not disassemble or alter the battery.

To avoid the risk of electrical shock or injury, do not open the battery enclosure on the PowerPack battery pack.

To avoid the risk of a shock hazard, do not plug the stand's power cord into a multiple portable socket outlet (MPSO) or use an extension cord.

To avoid possible electrical shock or electromagnetic interference, verify proper operation and compliance with relevant safety standards for all equipment before clinical use. Connecting additional equipment to the ultrasound system constitutes configuring a medical system. SonoSite recommends verifying that the system, all combinations of equipment, and accessories connected to the ultrasound system comply with JACHO installation requirements and/or safety standards AAMI-ES1, NFPA 99, IEC 60601-1-1, and IEC 60601-1-2, and are certified according to IEC 60950 (Information Technology Equipment (ITE)).

**Caution:**

To prevent the battery from draining, do not connect the PowerPack DC power cord to its own—or another PowerPack's—DC input port.

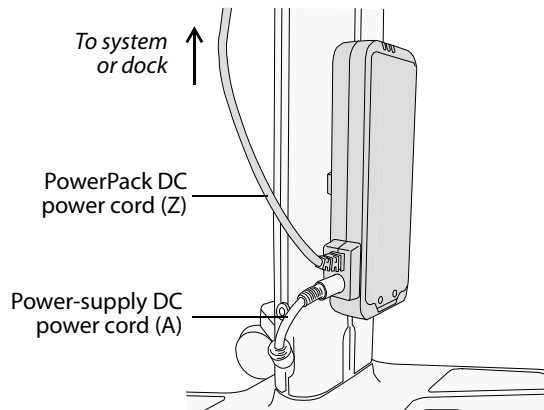

Figure 7 Connect cables A and Z

**Cables and connectors**

<b>Cable</b> [Letter] [Name] [Illustration]	<b>Connector 1</b> [Illustration] [Connects to]	<b>Connector 2</b> [Illustration] [Connects to]
--	---	---

<b>A</b> Power-supply DC power cord 6.8 ft./2 m		<i>Pre-installed on stand</i>
	PowerPack DC input port	

<b>K</b> System AC power cord 10 ft./3 m		
	Stand	Wall outlet

<b>Z</b> PowerPack DC power cord	<i>Pre-installed on PowerPack</i>	
		DC input on mini-dock, NanoMaxx dock, or system

---

## Technical Support

### SonoSite Technical Support

Phone 877-657-8118  
(US or Canada):

Phone 425-951-1330  
(Outside US and Or call your local  
Canada): representative.

Fax: 425-951-6700

E-mail: service@sonosite.com

Web site: www.sonosite.com

### Europe Service Center

Phone: +44-(0)1462-444-800

E-mail: uk.service@sonosite.com

H-Universal, SonoSite, V-Universal, and the SonoSite logo are trademarks or registered trademarks of SonoSite, Inc.

Non-SonoSite product names may be trademarks or registered trademarks of their respective owners.

Patents pending.

**Caution:**

Federal (United States) law restricts this device to sale by or on the order of a physician.

**SonoSite, Inc.**  
21919 30th Drive SE  
Bothell, WA 98021 USA  
T: 1-888-482-9449 or  
1-425-951-1200  
F: 1-425-951-1201

**SonoSite Ltd**  
Alexander House  
40A Wilbury Way  
Hitchin, Herts  
SG4 OAP UK  
T: +44-1462-444800  
F: +44-1462-444801

07/2010  
Copyright 2010 by  
SonoSite, Inc.  
All rights reserved.



P13537-01

